

HOUSING EXTRUSION

- PRF-S1-HE-CCC-M-2
- PRF-S1-HE-CCC-M-4
- PRF-S1-HE-CCC-M-8

*CCC-M = color and material
 GRY-A = Gray Acrylic
 BLK-P = Black Polycarbonate*

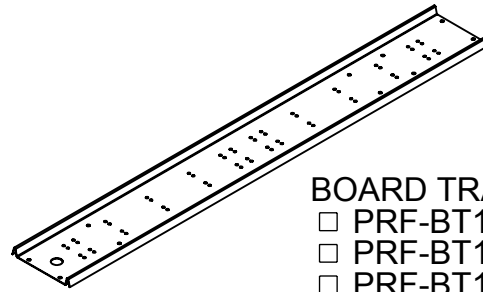

BOARD TRAYS

- PRF-BT1-LZH-2
- PRF-BT1-LZH-4
- PRF-BT1-LZH-8
- PRF-BT1-PES-4

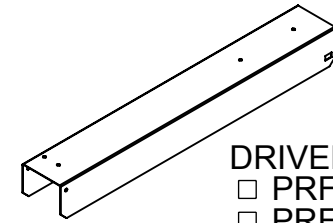

DRIVER CHANNEL

- PRF-DC1-16
- PRF-DC1-20

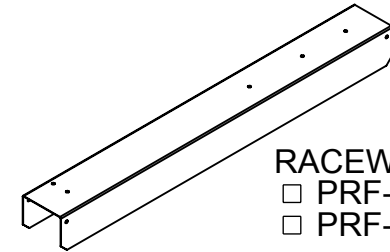

RACEWAY (option)

- PRF-RW1-2
- PRF-RW1-4

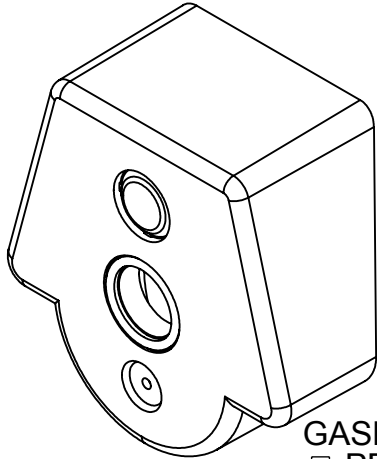

GASKETED END CAP
 PRF-S1-EC-BLK-N-S

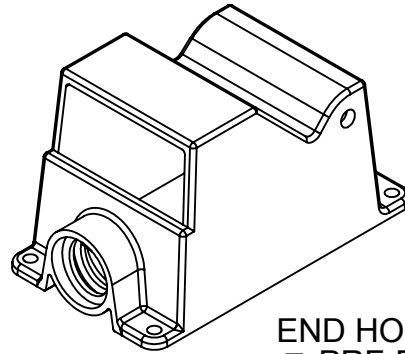

END HOLD
 PRF-EH-BLK-N

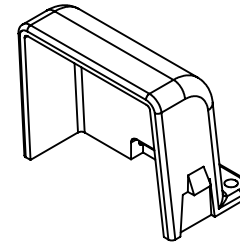

CHANNEL HOLD
 PRF-CH-BLK-N

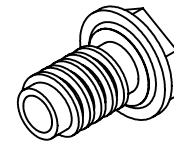

ACME SCREW
 PRF-AS-BLK-N

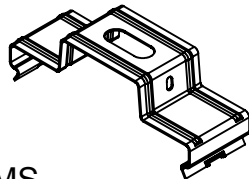

MOUNTING BRACKET
 PRF-MB

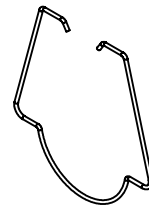

SAFETY BAIL (optional)
 PRF-S1-SB

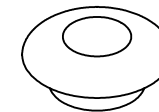

0.50" Grommet
 SLP-GRMT-0500

OTHER ITEMS

- SLP-SCRW-850
- R.PR10101953 (rivet)
- CT-SCRW-UGT

ITEMS SUPPLIED BY OTHER

- GORE VENT
- Cord Grip
- LED MODULES and DRIVERS



For IP Applications, SLP has tested and verified the use of the PolyVent High Airflow plug, supplied by GORE. Part # PMF100585

ASSEMBLY GUIDE

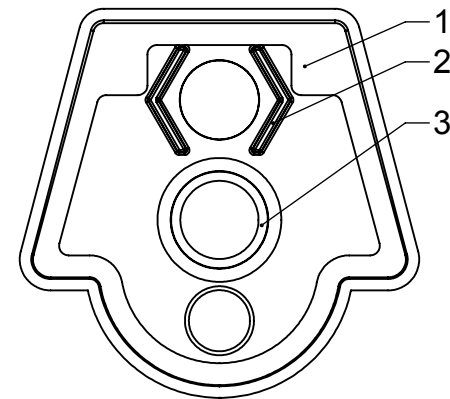
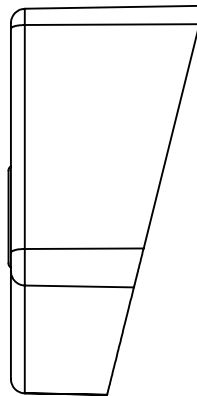
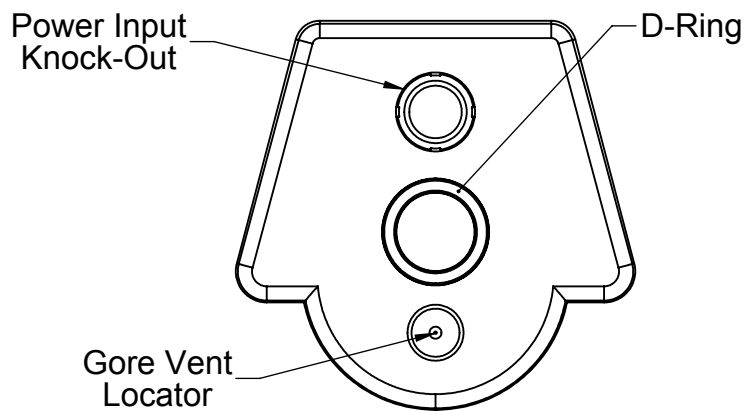

It will be the responsibility of the assembler to prep the end cap for assembly.

This includes...

- Knocking out and cleaning up the power feed K.O.
 - Drilling a 0.500" hole for the Gore Vent.
- *** The Gore Vent can be used on either or both end caps.

The inside of the end cap has several key features.

1. The Liquid Silicon Rubber gasket which is pre-adhered to the end cap.
2. The locknut wall to ease tightening of the cord grip used for the power input feed.
3. The center boss serves as a stop in cases of over tightening to protect the gasket.

The Channel Hold always point toward the .500 hole for the LED power wires.

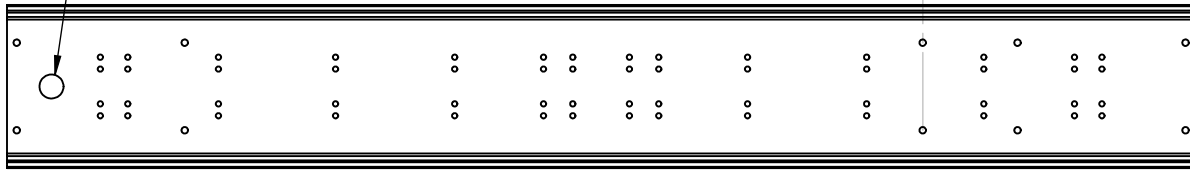
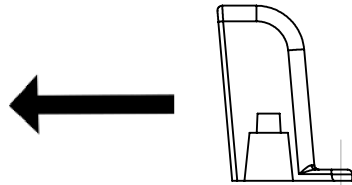

The Channel and End Holds placed on top of the Board Tray

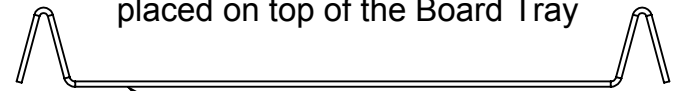

LED Board Side

These components are designed to be attached using rivets for fast assembly. Using screws is optional.

It is suggested that aluminum rivets with .125" diameter .250" long shank are used.

Direction of rivet is to be determined by the assembler.

Always use a grommet.

The End Holds always point outward.

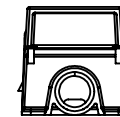
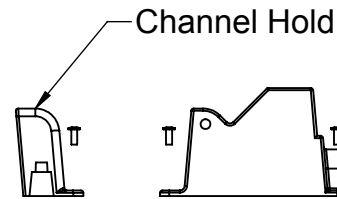
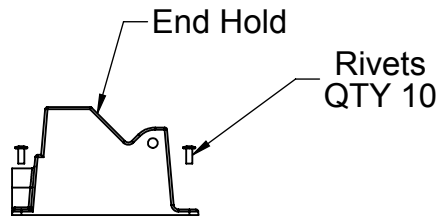
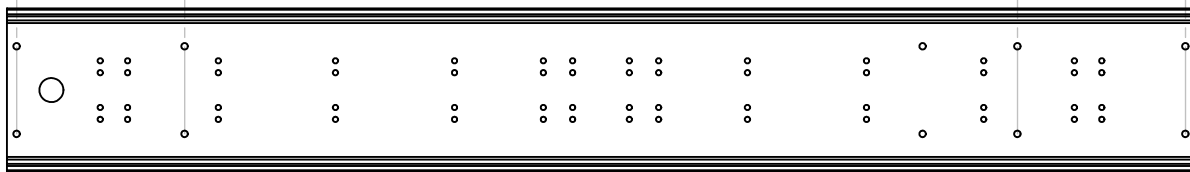
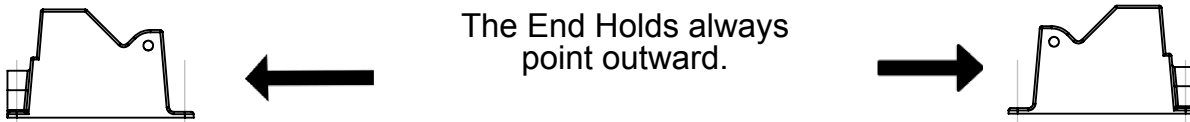

SLP-GRMT-0500
1/2" Grommet

Profile Series Board Tray

Zhaga LED Module

SLP-SCRW-850

ASSEMBLY GUIDE

Attach the driver tray, first end cap and complete the wiring.

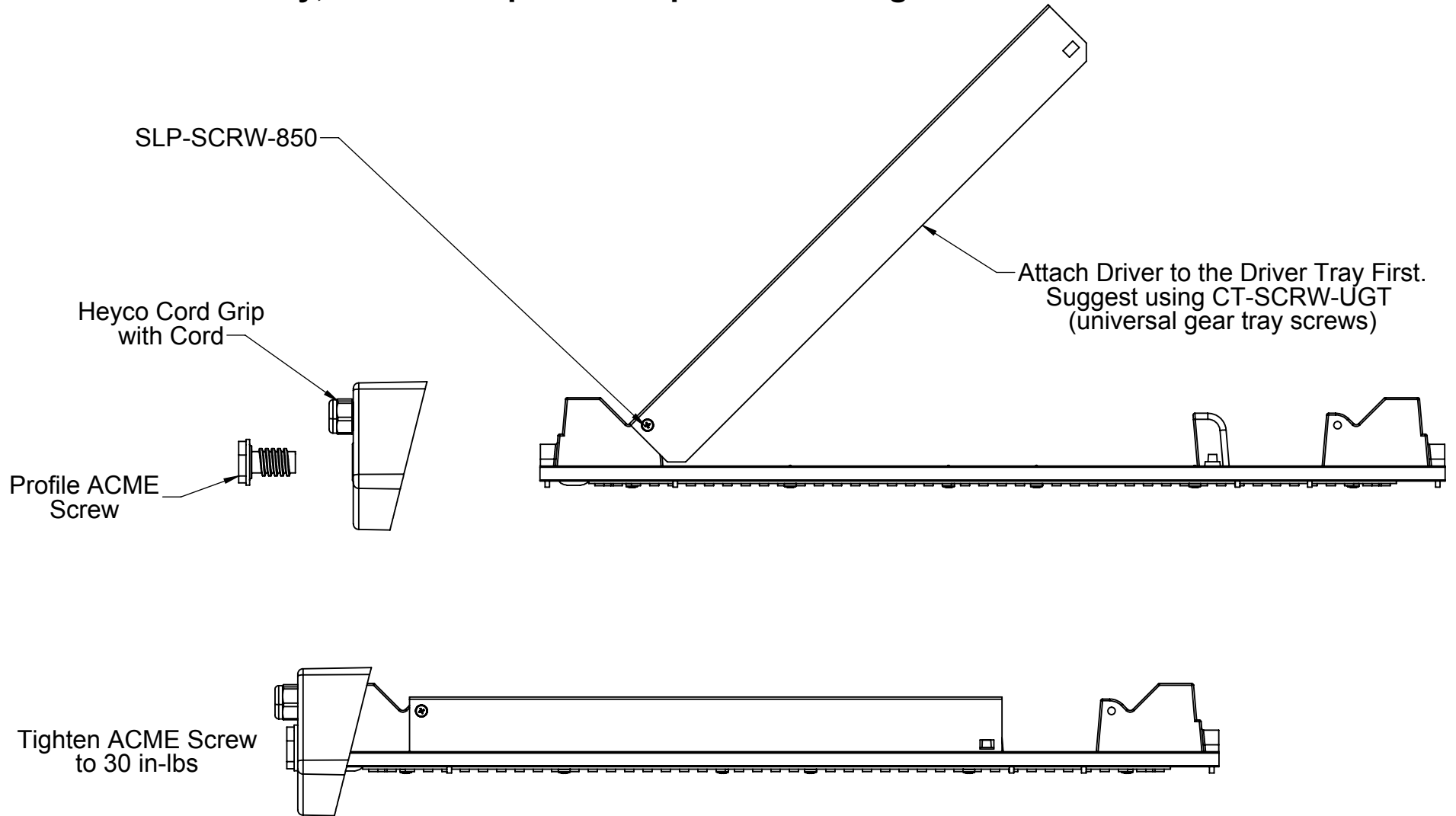

ASSEMBLY GUIDE

Page 4 of 11

ALTERNATIVE RACEWAY DESIGN

Rather than using the driver channel,

When using the raceway, the assembly **does not** require the channel hold, PRF-CH-BLK-N.

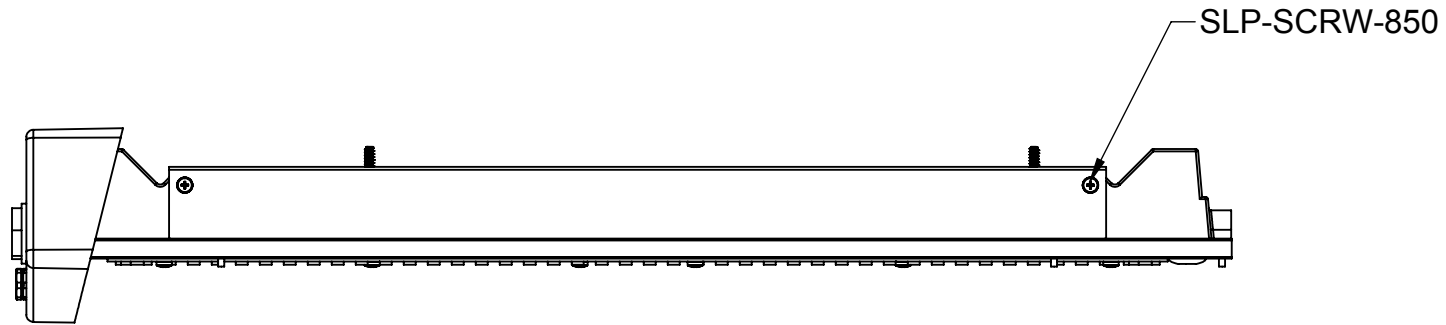
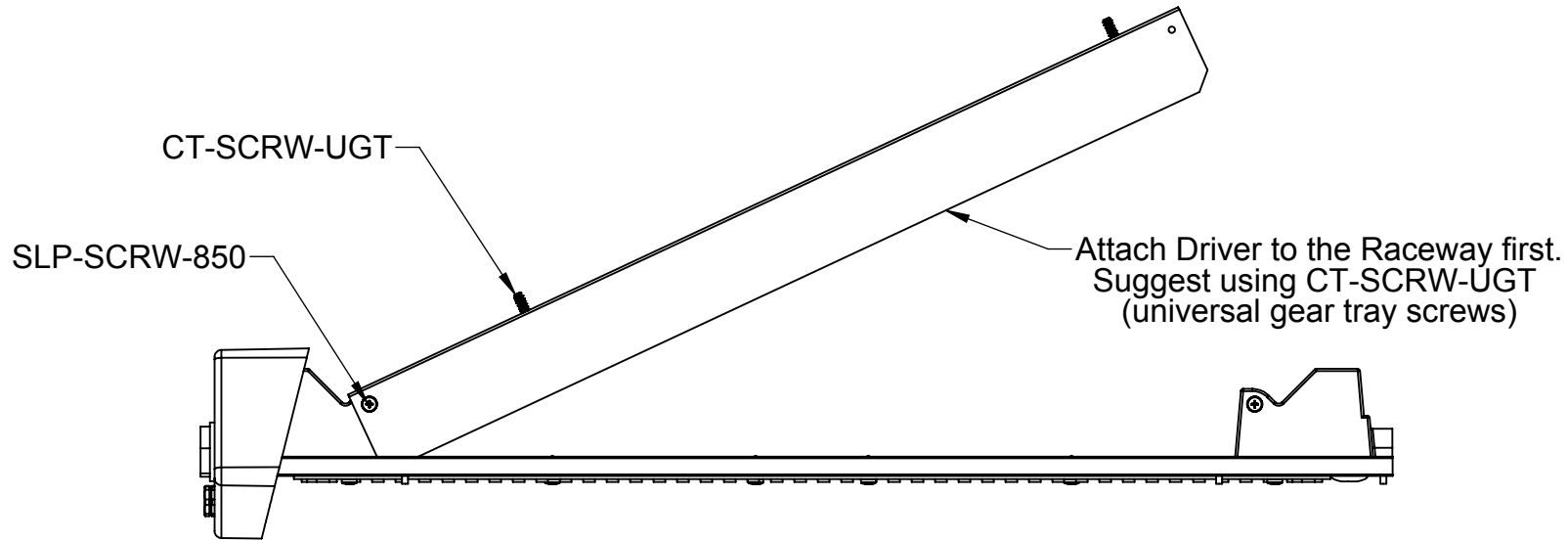

ASSEMBLY GUIDE

Page 5 of 11

Driver Channel Vs Raceway Comparison

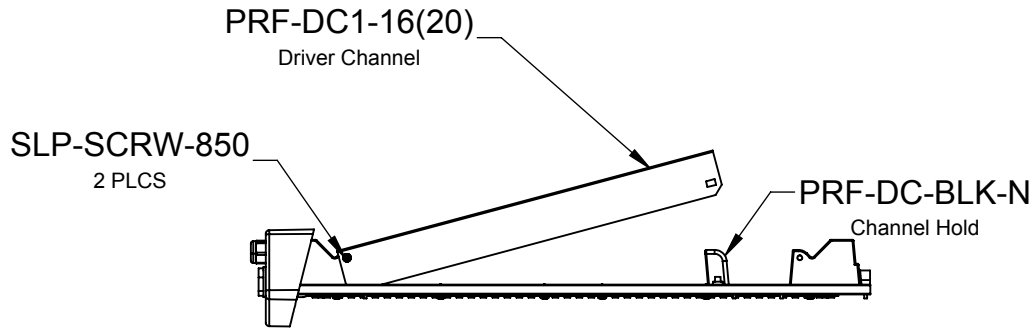

Profile Series with Driver Channel

Channel Hold Required

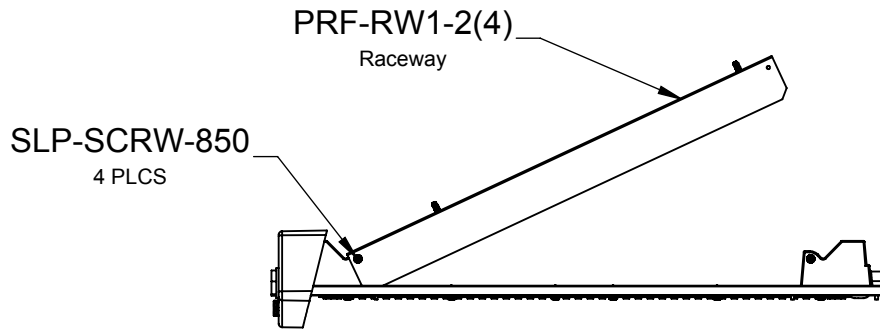
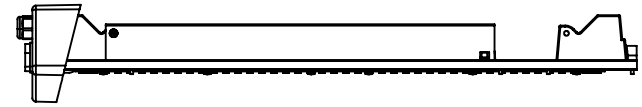

Profile Series with Raceway

No Channel Hold Required

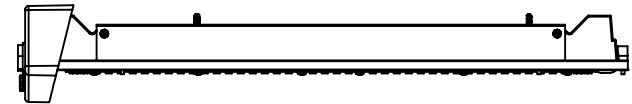

Raceway fully attached via screws.

ASSEMBLY GUIDE

Page 6 of 11

Slide assembly into the Profile Tube and attach second end cap.

Tighten Acme Screw to 30 in-lbs.

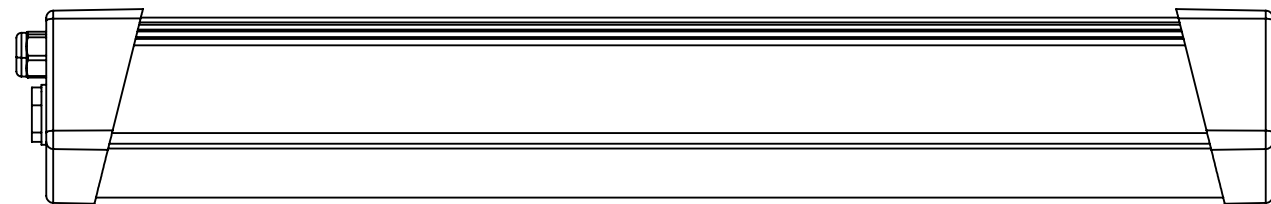
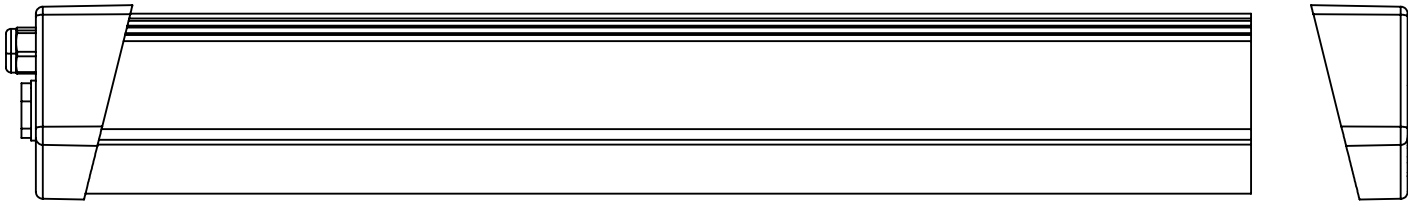
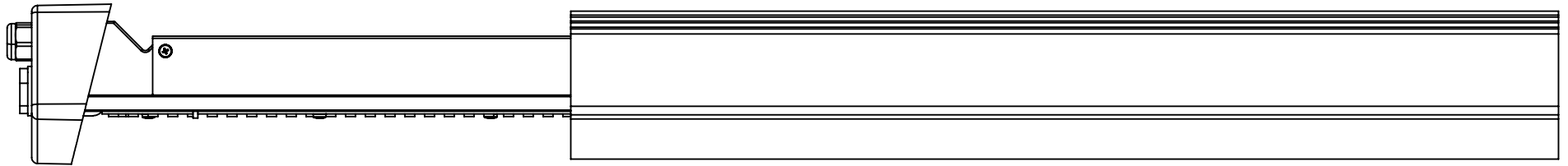

Gore Vent can be used on either or both end caps. Depends on the end cap preparation and fixture wattage.

TYPICAL 2FT PROFILE 1 ASSEMBLY BOM

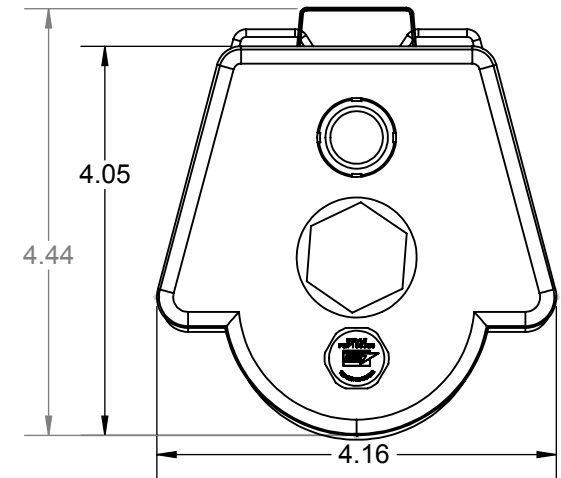
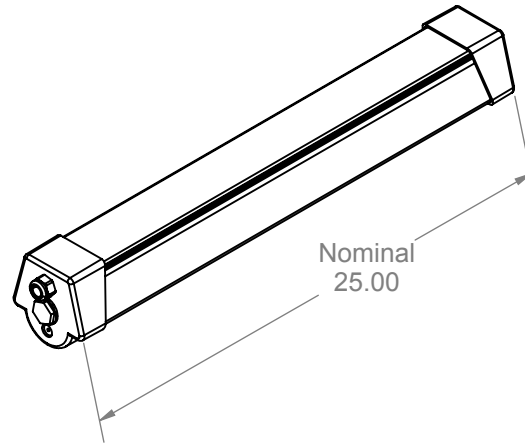
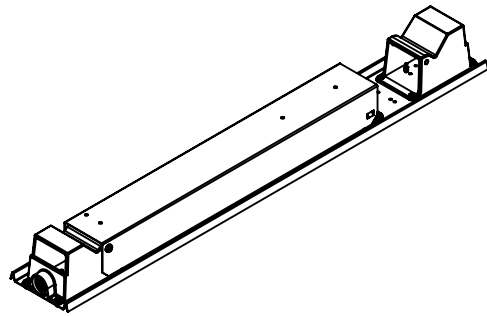

SLP Supplied Components

ITEM NO.	PART NUMBER	DESCRIPTION	QTY.
1*	*PRF-S1-HE-CCC-M-2	Profile Series 1 Extruded Housing, 2FT	1
2	PRF-S1-EC-BLK-N-S	Profile Series 1 End Caps, modified per needs.	2
3	PRF-EH-BLK-N	End Hold	2
4	PRF-AS-BLK-N	Acme Screw	2
5	PRF-CH-BLK-N	Channel Hold	1
6	PRF-BT1-LZH-2	2FT Linear Zhaga Board Tray	1
7	PRF-DC1-16	16 Inch Driver Channel	1
8	GORE PMF100585	GORE PolyVent High Airflow	1
9	PRF-MB	Profile Mounting Bracket	2
10	SLP-GRMT-0500	1/2" Grommet	1
11	R.PR10101953	0.140 Aluminum Rivet	10
12	SLP-SCRW-850	#8 SM Screw	as needed
13	CT-SCRW-UGT	Universal Gear Tray Screw	as needed

*CCC-M = color and material
 GRY-A = Gray Acrylic
 BLK-P = Black Polycarbonate

LED Modules and Drivers Supplied by Others

*Varies per board

ASSEMBLY GUIDE

Page 8 of 11

TYPICAL 4FT PROFILE 1 ASSEMBLY BOM

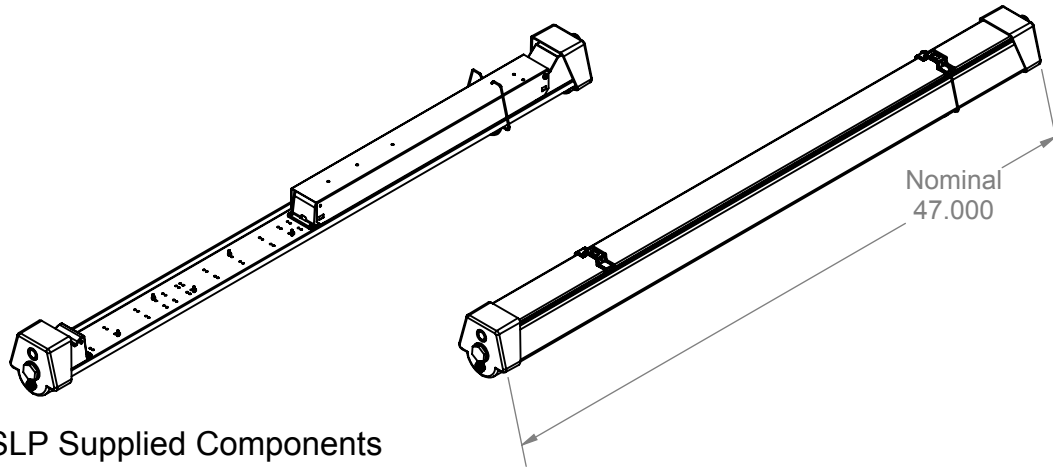

SLP Supplied Components

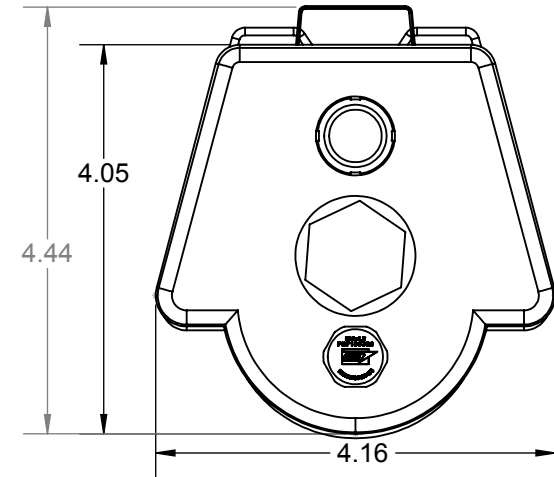

ITEM NO.	PART NUMBER	DESCRIPTION	QTY.
1*	*PRF-S1-HE-CCC-M-4	Profile Series 1 Extruded Housing 4FT	1
2	PRF-S1-EC-BLK-N-S	Profile Series 1 End Caps, Modified per needs.	2
3	PRF-EH-BLK-N	End Hold	2
4	PRF-AS-BLK-N	Acme Screw	2
5	PRF-CH-BLK-N	Channel Hold	1
6	PRF-BT1-LZH-4	4FT Linear Zhage Board Tray	1
7	PRF-DC1-20	20 Inch Driver Channel	1
8	GORE PMF100585	GORE PolyVent High Airflow	1
9	PRF-MB	Mounting Bracket	2
10	SLP-GRMT-0500	1/2" Grommet	1
11	R.PR10101953	0.140 Aluminum Rivet	10
12	SLP-SCRW-850	#8 SM Screw	as needed
13	CT-SCRW-UGT	Universal Gear Tray Screw	as needed

* CCC-M = color and material
 GRY-A = Gray Acrylic
 BLK-P = Black Polycarbonate

LED Modules and Drivers Supplied by Others

*Varies per board

ASSEMBLY GUIDE

Page 9 of 11

TYPICAL 8FT PROFILE 1 ASSEMBLY BOM

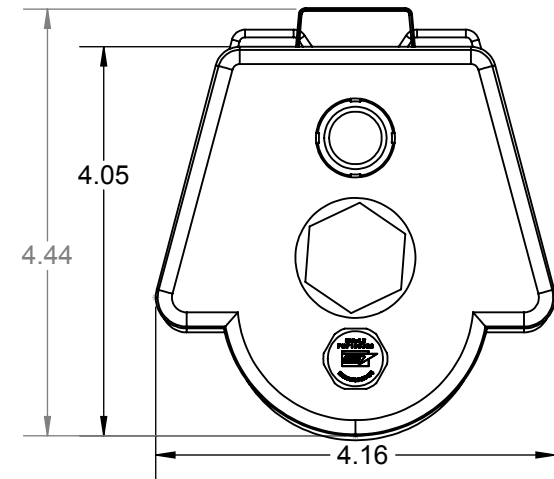
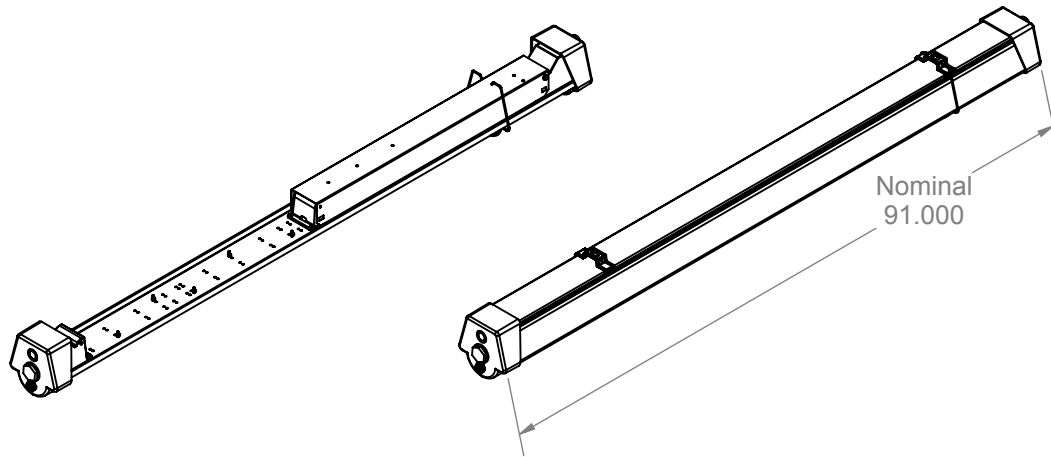

ITEM NO.	PART NUMBER	DESCRIPTION	QTY.
1*	*PRF-S1-HE-CCC-M-8	Profile Series 1 Extruded Housing 8FT	1
2	PRF-S1-EC-BLK-N-S	Profile Series 1 End Caps, Modified per needs.	2
3	PRF-EH-BLK-N	End Hold	2
4	PRF-AS-BLK-N	Acme Screw	2
5	PRF-CH-BLK-N	Channel Hold	1
6	PRF-BT1-LZH-8	8FT Linear Zhage Board Tray	1
7	PRF-DC1-20	20 Inch Driver Channel	1
8	GORE PMF100585	GORE PolyVent High Airflow	2
9	PRF-MB	Mounting Bracket	3
10	SLP-GRMT-0500	1/2" Grommet	1
11	R.PR10101953	0.140 Aluminum Rivet	10
12	SLP-SCRW-850	#8 SM Screw	As needed
13	CT-SCRW-UGT	Universal Gear Tray Scew	as needed

* CCC-M = color and material
 GRY-A = Gray Acrylic
 BLK-P = Black Polycarbonate

LED Modules and Drivers Supplied by Others

*Varies per board

ASSEMBLY GUIDE

Page 10 of 11

TYPICAL 4FT PROFILE 1 PHILIPS EASESELECT ASSEMBLY BOM

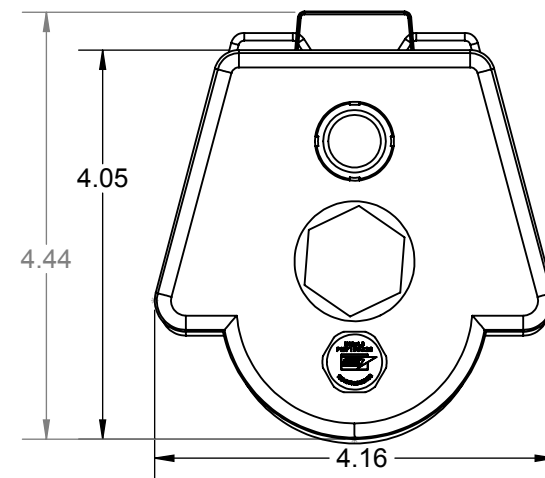
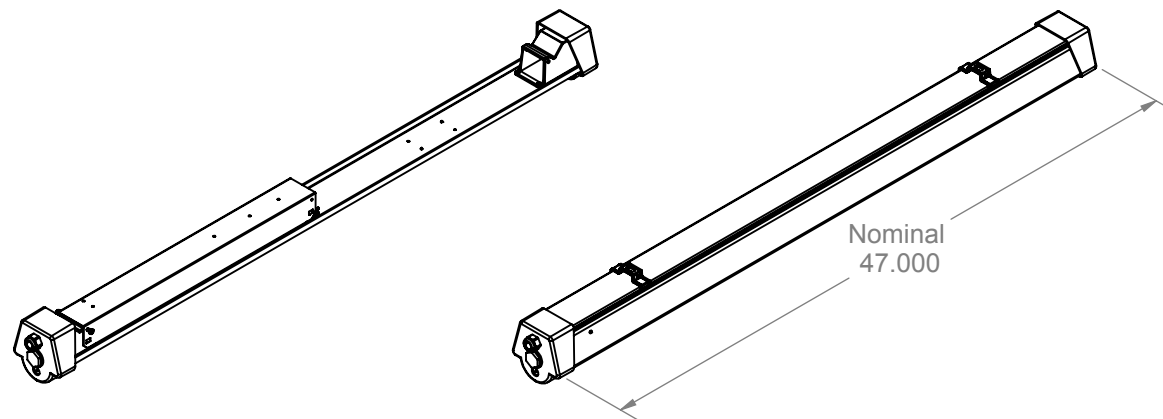

BOM Table

ITEM NO.	PART NUMBER	DESCRIPTION	QTY.
1*	*PRF-S1-HE-CCC-M-4	Profile series 1 Extruded Housing, 4FT	1
2	PRF-S1-EC-BLK-N-S	Profile Series 1 End Caps, modified per needs.	2
3	PRF-EH-BLK-N	End Hold	2
4	PRF-AS-BLK-N	Acme Screw	2
5	PRF-CH-BLK-N	Channel Hold	1
6	PRF-BT1-PES-4	4FT Philips Ease Select Board Tray	1
7	PRF-DC1-20	20 Inch Driver Channel	1
8	GORE PMF100585	GORE PolyVent High Airflow	1
9	PRF-MB	Profile Mounting Bracket	2
10	R.PR10101953	0.140 Aluminum Rivet	10
11	SLP-SCRW-850	#8 SM Screw	as needed
12	CT-SCRW-UGT	universal gear tray screw	as needed

* CCC-M = color and material
 GRY-A = Gray Acrylic
 BLK-P = Black Polycarbonate

EaseSelect Board and Driver Supplied by others.

*Varies per board

ASSEMBLY GUIDE

Page 11 of 11