

REPRESENTED BY SLP LIGHTING
1400 S. OLD HIGHWAY 141
FENTON, MO 63026 USA
PHONE: 800.248.0224 / 636.600.4084
SALES@SLPLIGHTING.COM
WWW.SLPLIGHTING.COM

Metal Parts Supplier



Illuminating
ENGINEERING SOCIETY



CORISCO ROT



Features and Benefits

- Pendant Mounted;
- Post Painted in Matte White Finish with 92% reflectance;
- Acrylic Technical Frosted diffuser with 80% light transmission;
- Formed and welded in 22 Gauge Steel;
- Can be mounted individually or in continuous row;
- Easy removal of diffuser, without any tools;
- Customized LED Pattern Holes available, verify with the Factory;

Dimensions

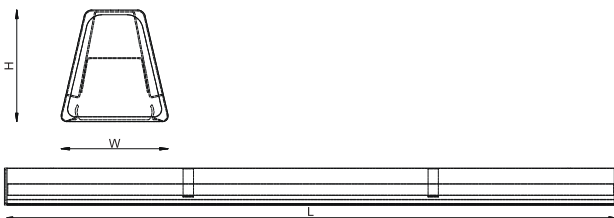

DIMENSIONS	LAMPS	H	W	L
2FT	Led	2.79	2.79	23.89
4FT	Led	2.79	2.79	46.25

Polar Curve

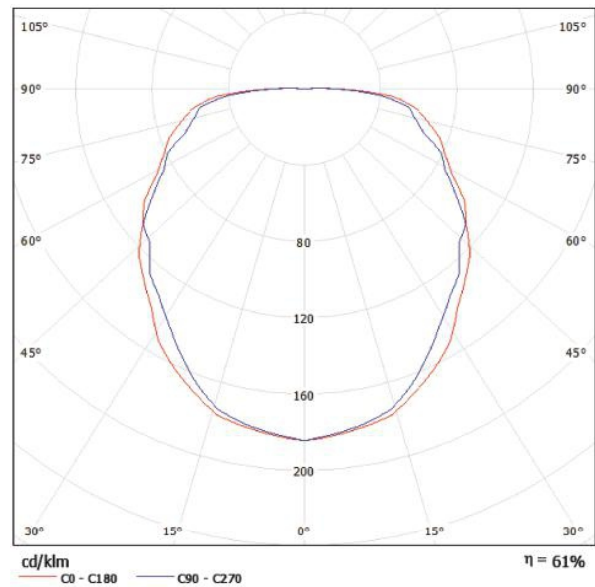

Technical Info

Product	Size	Listed	Light Outpt (Lm)	Wattage (W)	Efficacy (LM/W)	CCT (K)	CRI (%)
CORISCO ROT 2K308	2FT	Standard	2277,7	20,0	114,2	3000	82,9
CORISCO ROT 2K358			2321,0	20,0	116,3	3500	83,1
CORISCO ROT 2K408			2364,4	20,0	118,5	4000	83,2
CORISCO ROT 2K508			2451,1	20,0	122,9	5000	83,5
CORISCO ROT 4K308	4FT	Standard	3906,9	37,4	104,5	3000	82,9
CORISCO ROT 4K358			3981,3	37,4	106,5	3500	83,1
CORISCO ROT 4K408			4055,6	37,4	108,5	4000	83,2
CORISCO ROT 4K508			4204,3	37,4	112,4	5000	83,5



CORISCO ROT

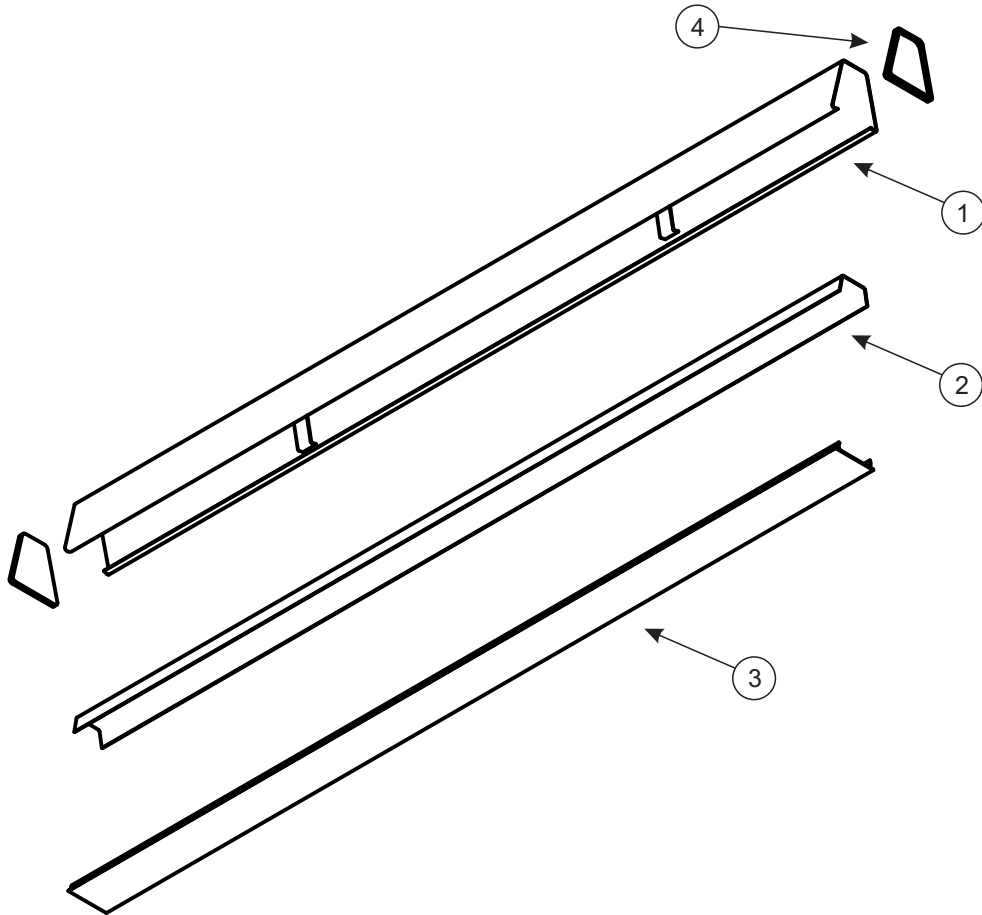

ITEM	QTY	DESCRIPTION	PART NUMBER
1	1	Body	Cor 1410
2	1	Led Chassis	Corrot 1406
3	1	Plastic Lens	375 2452
4	2	End Top (Optional)	Cor 16



PLIN 2325



Features and Benefits

- Pendant Mounted;
- Post Painted in Matte White Finish with 92% reflectance;
- Direct/indirect Light;
- Formed and welded in 22 Gauge Steel;
- Can be mounted individually or in continuous row;
- Acrylic Technical Frosted diffuser with 90% light transmission;
- Easy removal of diffuser, without any tools;
- Customized LED Pattern Holes available, verify with the Factory;

Dimensions

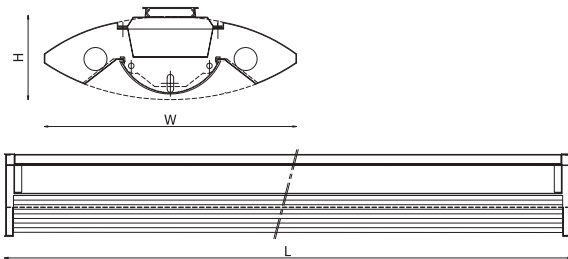

DIMENSIONS	LAMPS	H	W	L
4FT	Led	4.00	11.00	23.79
8FT	Led	4.00	11.00	94.17

Polar Curve

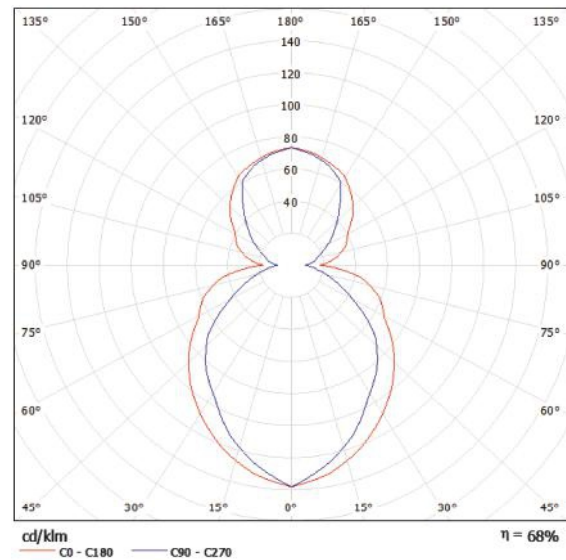

Technical Info

Product	Size	Listed	Light Outpt (Lm)	Wattage (W)	Efficacy (LM/W)	CCT (K)	CRI (%)
PLIN 2325 4K308	4FT	Standard	1.90Klm / 3.15Klm	48,3	104,5	3000	82,9
PLIN 2325 4K358			1.95Klm / 3.20Klm	48,3	106,5	3500	83,1
PLIN 2325 4K408			2.00Klm / 3.25Klm	48,3	108,5	4000	83,2
PLIN 2325 4K508			2.05Klm / 3.30Klm	48,3	112,4	5000	83,5
PLIN 2325 8K308	8FT	Standard	3.80Klm / 6.30Klm	96,6	104,5	3000	82,9
PLIN 2325 8K358			3.90Klm / 6.40Klm	96,6	106,5	3500	83,1
PLIN 2325 8K408			4.00Klm / 6.50Klm	96,6	108,5	4000	83,2
PLIN 2325 8K508			4.10Klm / 6.60Klm	96,6	112,4	5000	83,5



PLIN 2325

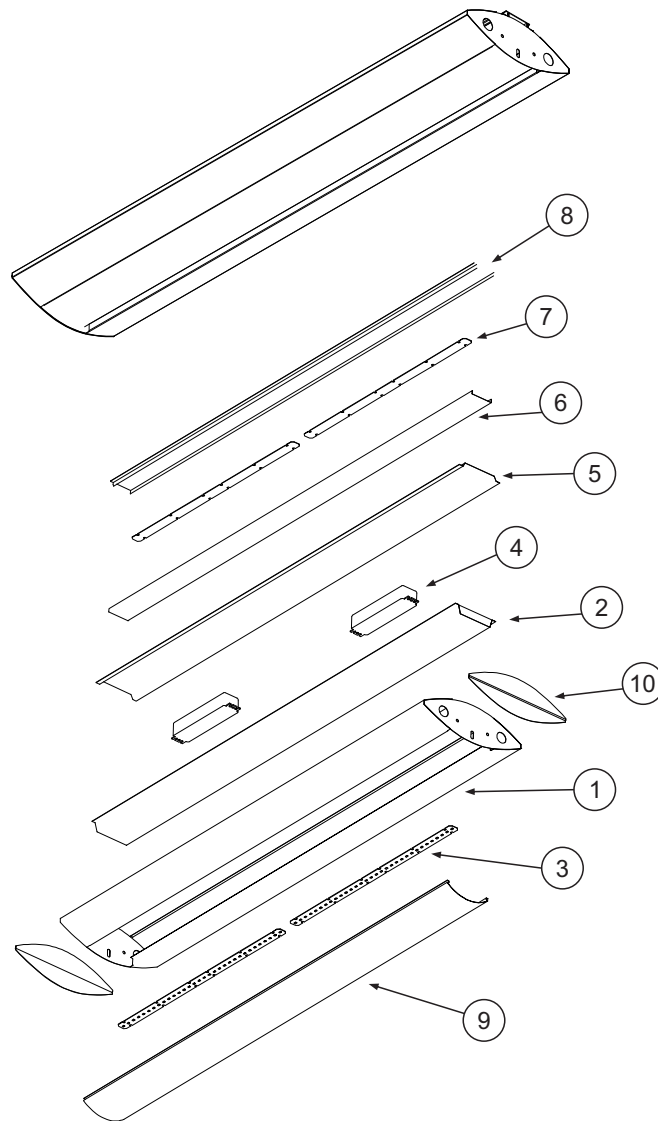

ITEM	QTY	DESCRIPTION	PART NUMBER
1	1	Body	2325 1410
2	1	Led Chassi	2325 1406
3	2	Led Boards	--
4	1 or 2	Driver	--
5	1	Ballast Cover	2325 1461
6	1	Lens Support UP Light	2325 1407
7	2	Led Boards	--
8	1	Plastic Lens	375 2542
9	1	Plastic Lens	474 2452
10	2	End Top (Optional)	2380 16
11	2	Joiner (Optional)	2380 17



LAL 1352 2"



Features and Benefits

- Pendant or surface mounted;
- Post Painted in Matte White Finish with 92% reflectance;
- Acrylic Technical Frosted difuser with 90% light transmission;
- Formed and welded in 24 Gauge Steel;
- Can be mounted individually or in continuous row;
- Easy removal of difuser, without any tools;
- Customized LED Pattern Holes available, verify with the Factory;

Dimensions

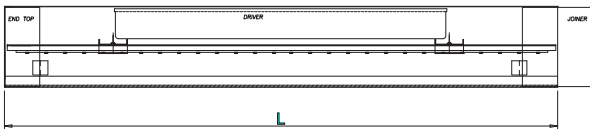
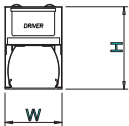

DIMENSIONS	LAMPS	H	W	L
2FT	Led	3.35	2.36	23.10
4FT	Led	3.35	2.36	46.30
8FT	Led	3.35	2.36	92.48

Polar Curve

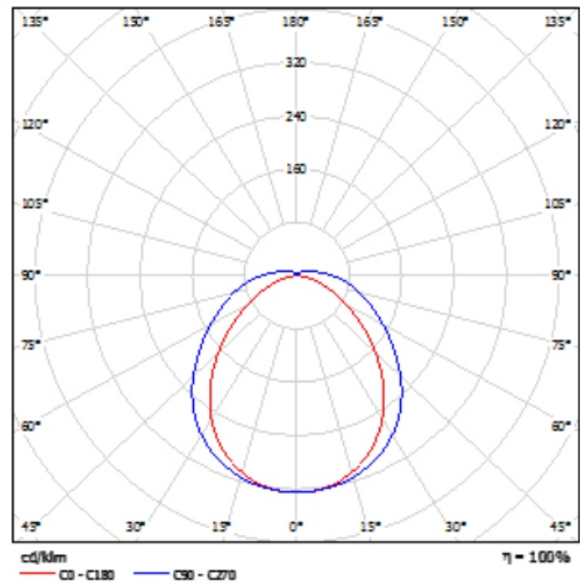

Technical Info

Product	Size	Listed	Light Outpt (Lm)	Wattage (W)	Efficacy (LM/W)	CCT (K)	CRI (%)
LAL 1352 22K308	2FT	Standard	2277,7	20,0	114,2	3000	82,9
LAL 1352 22K358			2321,0	20,0	116,3	3500	83,1
LAL 1352 22K408			2364,4	20,0	118,5	4000	83,2
LAL 1352 22K508			2451,1	20,0	122,9	5000	83,5
LAL 1352 24K308	4FT	Standard	3906,9	37,4	104,5	3000	82,9
LAL 1352 24K358			3981,3	37,4	106,5	3500	83,1
LAL 1352 24K408			4055,6	37,4	108,5	4000	83,2
LAL 1352 24K508			4204,3	37,4	112,4	5000	83,5
LAL 1352 28K308	8FT	Standard	6605,5	63,5	104,1	3000	83,5
LAL 1352 28K358			6731,2	63,5	106,0	3500	83,1
LAL 1352 28K408			6856,9	63,5	108,0	4000	83,2
LAL 1352 28K508			7108,3	63,3	112,2	5000	83,5



LAL 1352 2"

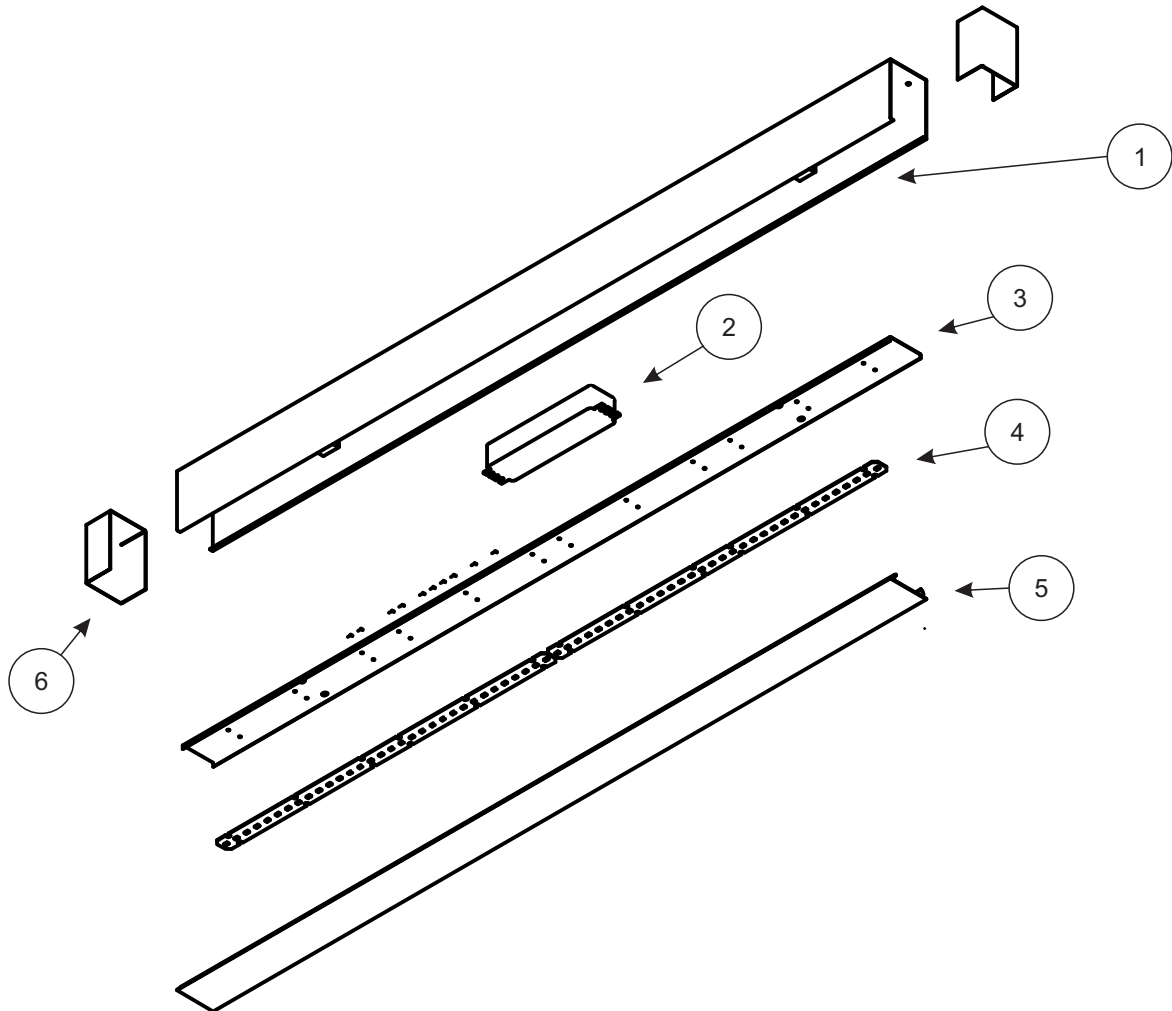

ITEM	QTY	DESCRIPTION	PART NUMBER
1	1	Body	1352 2410
2	1	Driver	--
3	2	Led Chassi	1552 2406
4	1	Led Board	--
5	-	Plastic Lens	375 2452
6	2	End Top (Optional)	1552 2416
7	1	Joiner (Optional)	1552 2417



LAL 1552 2"



Features and Benefits

- Recessed Mounted;
- Post Painted in Matte White Finish with 92% reflectance;
- Acrylic Technical Frosted diffuser with 90% light transmission;
- Formed and welded in 22 Gauge Steel;
- Can be mounted individually or in continuous row;
- Easy removal of diffuser, without any tools;
- Customized LED Pattern Holes available, verify with the Factory;

Dimensions

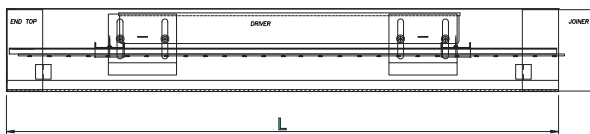
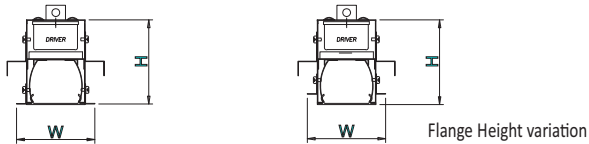

DIMENSIONS	LAMPS	H	W	L
2FT	Led	3.35	3.15	23.10
4FT	Led	3.35	3.15	46.30
8FT	Led	3.35	3.15	92.48

Polar Curve

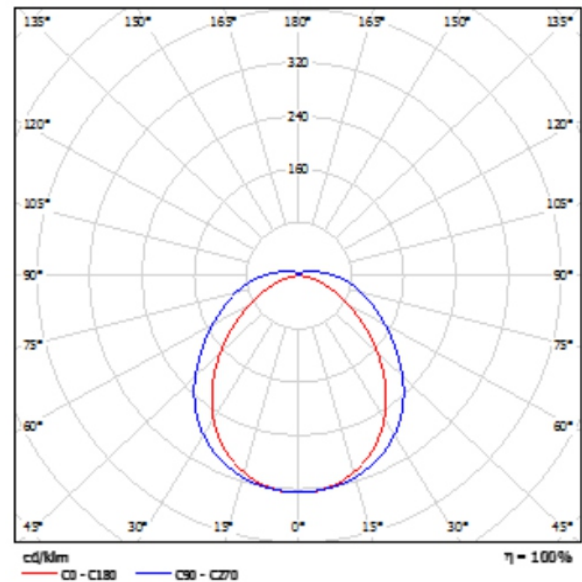

Technical Info

Product	Size	Listed	Light Outpt (Lm)	Wattage (W)	Efficacy (LM/W)	CCT (K)	CRI (%)
LAL 1552 22K308	2FT	Standard	2277,7	20,0	114,2	3000	82,9
LAL 1552 22K358			2321,0	20,0	116,3	3500	83,1
LAL 1552 22K408			2364,4	20,0	118,5	4000	83,2
LAL 1552 22K508			2451,1	20,0	122,9	5000	83,5
LAL 1552 24K308	4FT	Standard	3906,9	37,4	104,5	3000	82,9
LAL 1552 24K358			3981,3	37,4	106,5	3500	83,1
LAL 1552 24K408			4055,6	37,4	108,5	4000	83,2
LAL 1552 24K508			4204,3	37,4	112,4	5000	83,5
LAL 1552 28K308	8FT	Standard	6605,5	63,5	104,1	3000	83,5
LAL 1552 28K358			6731,2	63,5	106,0	3500	83,1
LAL 1552 28K408			6856,9	63,5	108,0	4000	83,2
LAL 1552 28K508			7108,3	63,3	112,2	5000	83,5



LAL 1552 2"

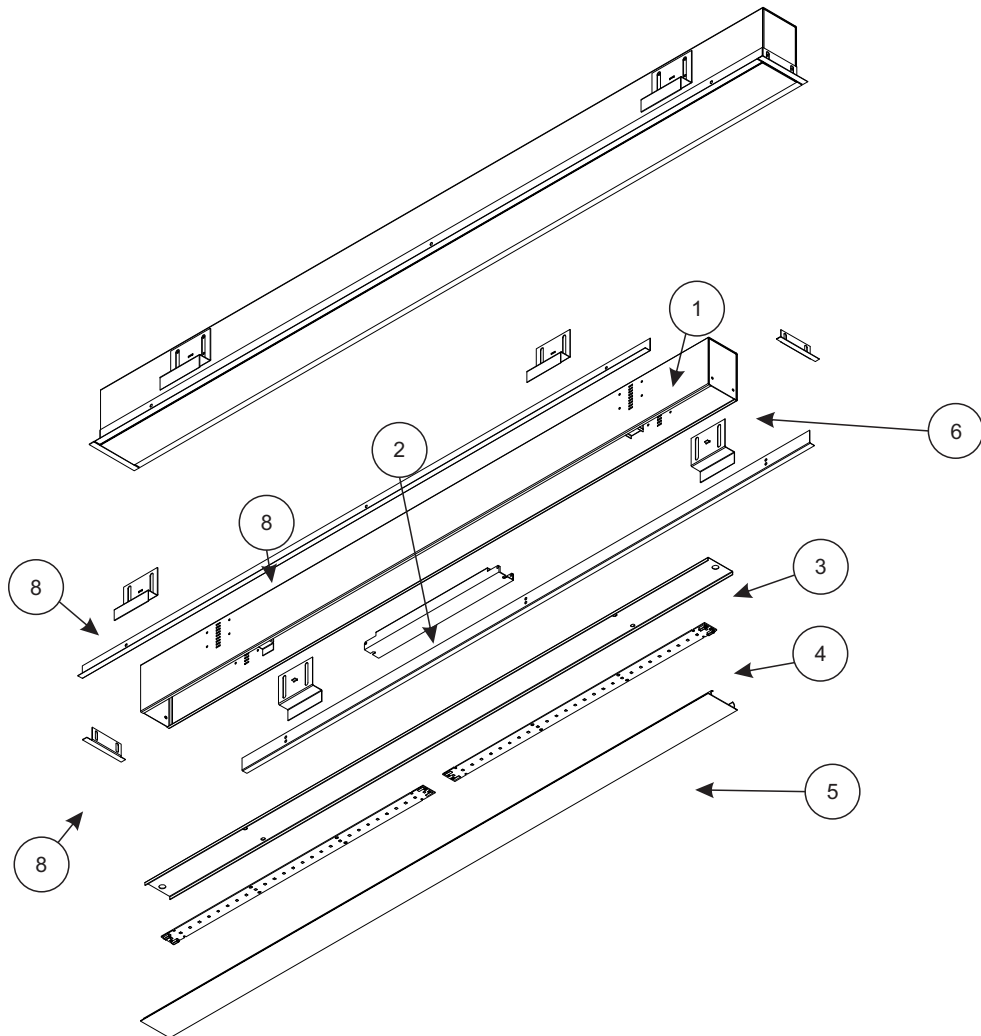

ITEM	QTY	DESCRIPTION	PART NUMBER
1	1	Body	1552 2410
2	1	Driver	--
3	1	Led Chassi	1552 2406
4	2	Led Boards	--
5	1	Plastic Lens	375 2452
6	2	End Top (Optional)	1552 2416
7	--	Joiner (Optional)	1552 2417
8	1	Kit Frame Modular Ceiling	1552 2401



LAL 1352 4"



Features and Benefits

- Pendant or surface mounted;
- Post Painted in Matte White Finish with 92% reflectance;
- Acrylic Technical Frosted difuser with 90% light transmission;
- Formed and welded in 24 Gauge Steel;
- Can be mounted individually or in continuous row;
- Easy removal of difuser, without any tools;
- Customized LED Pattern Holes available, verify with the Factory;

Dimensions

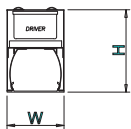

Flange Height variation

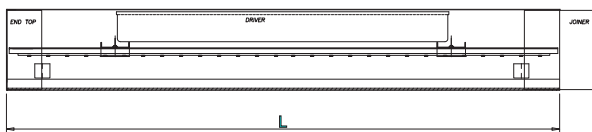

DIMENSIONS	LAMPS	H	W	L
2FT	Led	4.14	3.93	23.10
4FT	Led	4.14	3.93	46.30
8FT	Led	4.14	3.93	92.48

Polar Curve

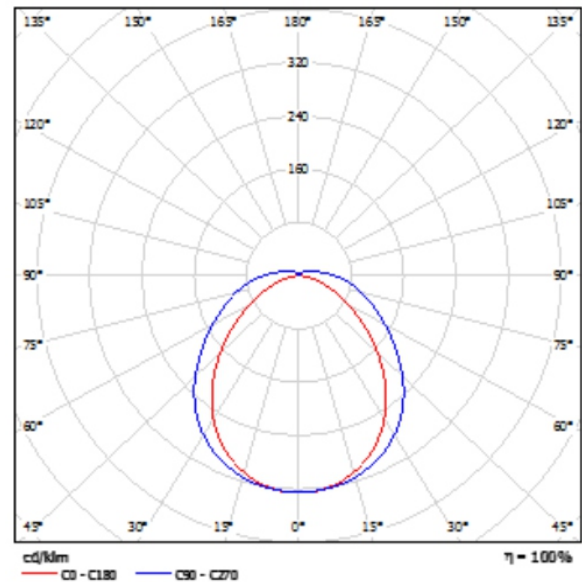

Technical Info

Product	Size	Listed	Light Outpt (Lm)	Wattage (W)	Efficacy (LM/W)	CCT (K)	CRI (%)
LAL 1352 42K308	2FT	Standard	2277,7	20,0	114,2	3000	82,9
LAL 1352 42K358			2321,0	20,0	116,3	3500	83,1
LAL 1352 42K408			2364,4	20,0	118,5	4000	83,2
LAL 1352 42K508			2451,1	20,0	122,9	5000	83,5
LAL 1352 44K308	4FT	Standard	3906,9	37,4	104,5	3000	82,9
LAL 1352 44K358			3981,3	37,4	106,5	3500	83,1
LAL 1352 44K408			4055,6	37,4	108,5	4000	83,2
LAL 1352 44K508			4204,3	37,4	112,4	5000	83,5
LAL 1352 48K308	8FT	Standard	6605,5	63,5	104,1	3000	83,5
LAL 1352 48K358			6731,2	63,5	106,0	3500	83,1
LAL 1352 48K408			6856,9	63,5	108,0	4000	83,2
LAL 1352 48K508			7108,3	63,3	112,2	5000	83,5



LAL 1352 4"

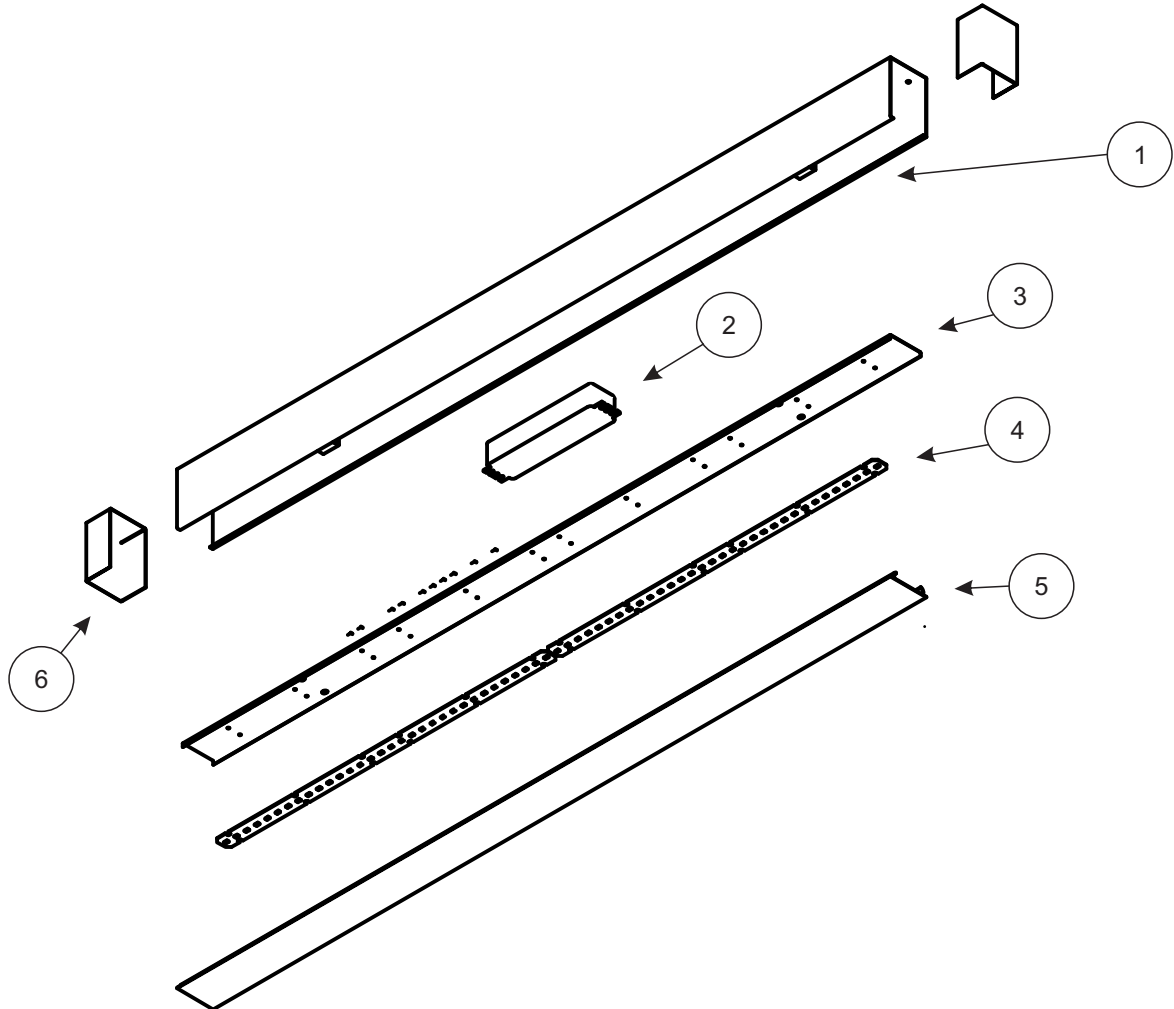

ITEM	QTY	DESCRIPTION	PART NUMBER
1	1	Body	1352 4410
2	1	Driver	--
3	1	Led Chassi	1352 4406
4	1	Led Board	--
5	1	Plastic Lens	1352 4452
6	2	End Top (Optional)	1352 4416
7	1	Joiner (Optional)	1352 4417



LAL 1552 4"



Features and Benefits

- Recessed Mounted;
- Post Painted in Matte White Finish with 92% reflectance;
- Acrylic Technical Frosted diffuser with 90% light transmission;
- Formed and welded in 22 Gauge Steel;
- Can be mounted individually or in continuous row;
- Easy removal of diffuser, without any tools;
- Customized LED Pattern Holes available, verify with the Factory;

Dimensions



Flange Height variation

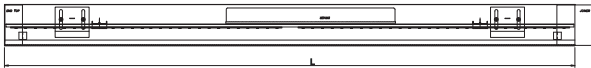

DIMENSIONS	LAMPS	H	W	L
2FT	Led	4.14	4.72	23.10
4FT	Led	4.14	4.72	46.30
8FT	Led	4.14	4.72	92.48

Polar Curve

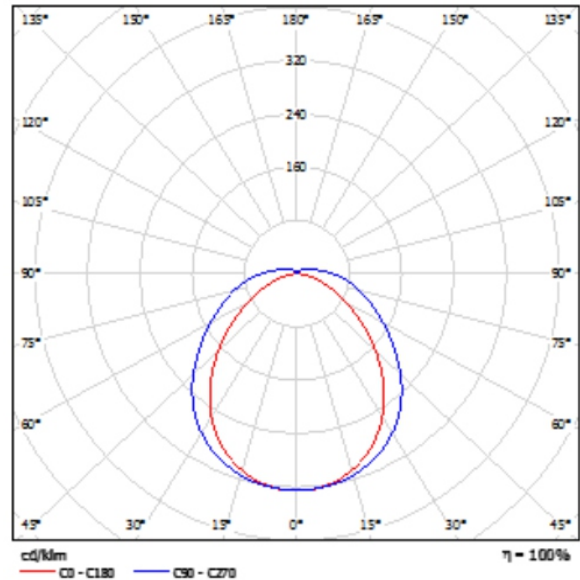

Technical Info

Product	Size	Listed	Light Outpt (Lm)	Wattage (W)	Efficacy (LM/W)	CCT (K)	CRI (%)
LAL 1552 42K308	2FT	Standard	2277,7	20,0	114,2	3000	82,9
LAL 1552 42K358			2321,0	20,0	116,3	3500	83,1
LAL 1552 42K408			2364,4	20,0	118,5	4000	83,2
LAL 1552 42K508			2451,1	20,0	122,9	5000	83,5
LAL 1552 44K308	4FT	Standard	3906,9	37,4	104,5	3000	82,9
LAL 1552 44K358			3981,3	37,4	106,5	3500	83,1
LAL 1552 44K408			4055,6	37,4	108,5	4000	83,2
LAL 1552 44K508			4204,3	37,4	112,4	5000	83,5
LAL 1552 48K308	8FT	Standard	6605,5	63,5	104,1	3000	83,5
LAL 1552 48K358			6731,2	63,5	106,0	3500	83,1
LAL 1552 48K408			6856,9	63,5	108,0	4000	83,2
LAL 1552 48K508			7108,3	63,3	112,2	5000	83,5



illuminating
ENGINEERING SOCIETY



LAL 1552 4"

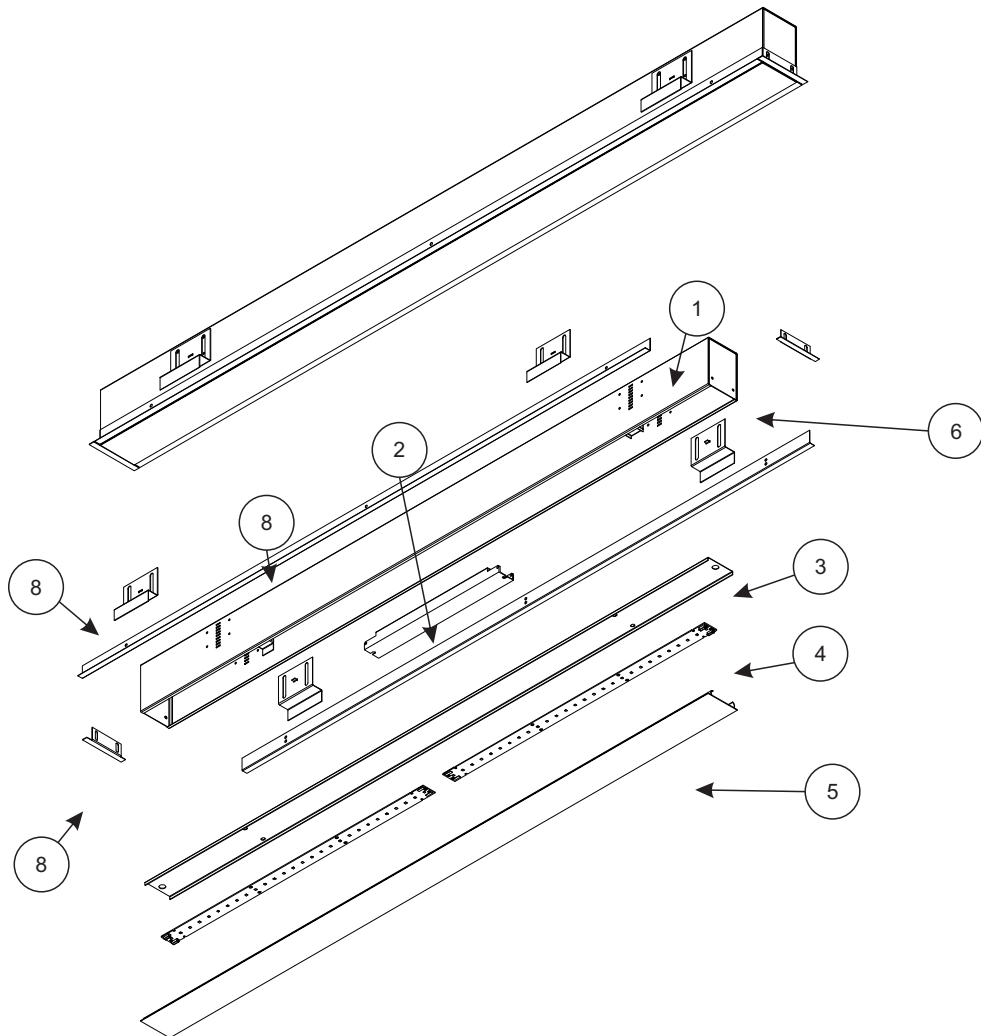

ITEM	QTY	DESCRIPTION	PART NUMBER
1	1	Body	1552 4410
2	1	Driver	--
3	1	Led Chassi	1352 4406
4	2	Led Boards	--
5	1	Plastic Lens	375 4452
6	2	End Top (Optional)	1552 4416
7	--	Joiner (Optional)	1352 4417
8	1	Kit Frame Modular Ceiling	1552 4401



CFL 574



Features and Benefits

- Recessed Mounted;
- Post Painted in Matte White Finish with 92% reflectance;
- Acrylic Technical Frosted diffuser with 90% light transmission;
- Formed and welded in 24 Gauge Steel;
- Easy removal of diffuser, without any tools;
- Customized LED Pattern Holes available, verify with the Factory;



Dimensions

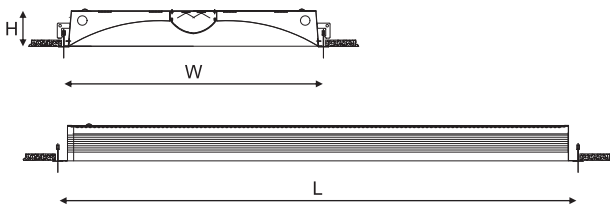

DIMENSIONS	LAMPS	H	W	L
1x4	Led	3.27	11.82	47.71
2x2	Led	3.27	23.72	23.72
2x4	Led	3.27	23.72	47.71

Polar Curve

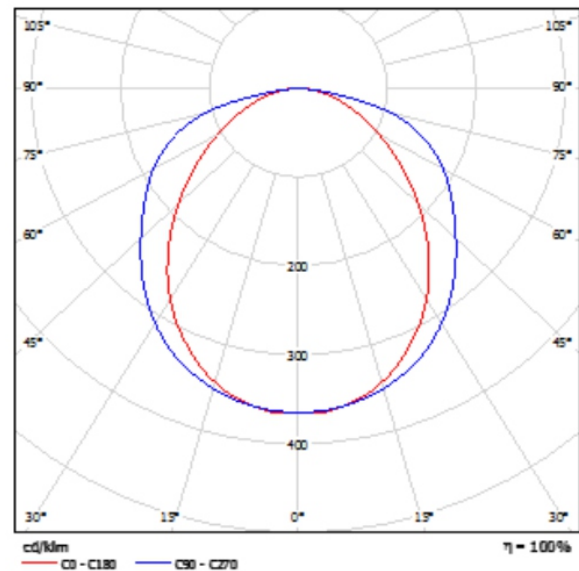

Technical Info

Product	Size	Listed	Light Outpt (Lm)	Wattage (W)	Efficacy (LM/W)	CCT (K)	CRI (%)
CFL 574 14K308	1x4	Standard	3824,8	37,7	101,4	3000	82,5
CFL 574 14K358			3903,0	37,5	104,1	3500	82,8
CFL 574 14K408			3981,2	37,7	105,5	4000	83,2
CFL 574 14K508			4137,5	37,7	109,7	5000	83,8
CFL 574 22K308	2x2	Standard	3816,0	37,7	101,0	3000	82,5
CFL 574 22K358			3894,0	37,9	102,8	3500	82,4
CFL 574 22K408			3972,0	37,9	104,9	4000	83,2
CFL 574 22K508			4128,0	37,9	109,0	5000	83,8
CFL 574 24K308	2x4	Standard	4803,6	43,5	106,8	3000	82,5
CFL 574 24K358			4901,8	43,5	112,7	3500	82,8
CFL 574 24K408			5000,0	43,5	114,9	4000	83,2
CFL 574 24K508			5196,3	43,5	119,5	5000	83,8



CFL 574

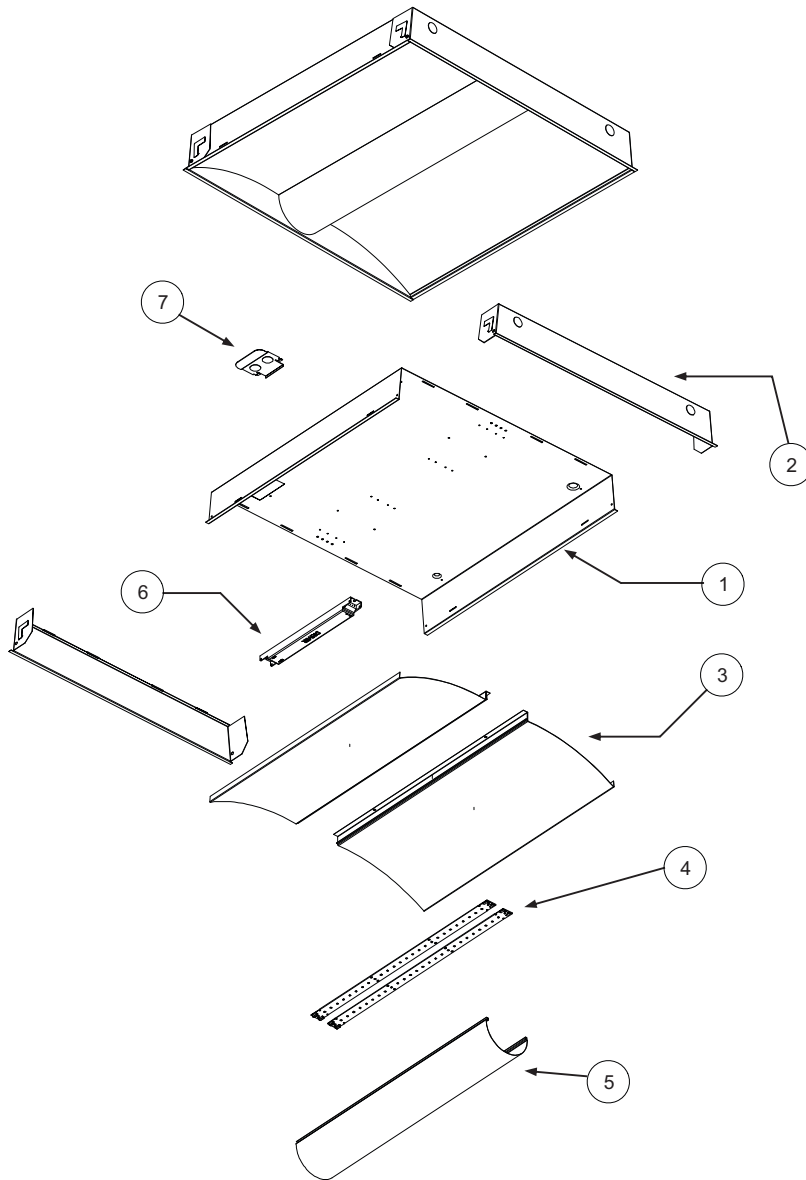

ITEM	QTY	DESCRIPTION	PART NUMBER
1	1	Body	574 2410
2	2	Headboard	574 2431
3	2	Side Reflector	574 2442
4	2	LED Board	--
5	1	Plastic Lens	474 2452
6	1	Power Supply	--
7	1	Access Plate	510 15



GDX 700



Features and Benefits

- Recessed or Surface mounted;
- Post painted in Matte White Finish with 92% reflectance;
- Acrylic technical frosted diffuser with 90% light transmission;
- Formed and welded in 24 Gauge Steel;
- Easy removal of frame, without any tools;
- Customized LED Pattern Holes available, verify with the Factory;
- High efficacy and newer design troffer;

Dimensions

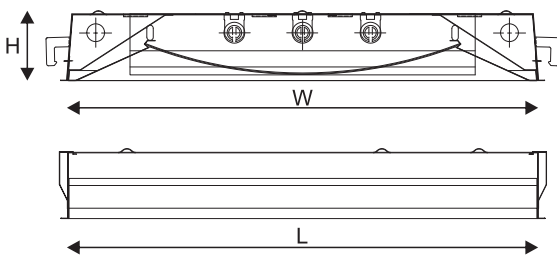

DIMENSIONS	LAMPS	H	W	L
1x4	Led	3.42	11.84	47.67
2x2	Led	3.42	23.72	23.72
2x4	Led	3.42	23.72	47.67

Polar Curve

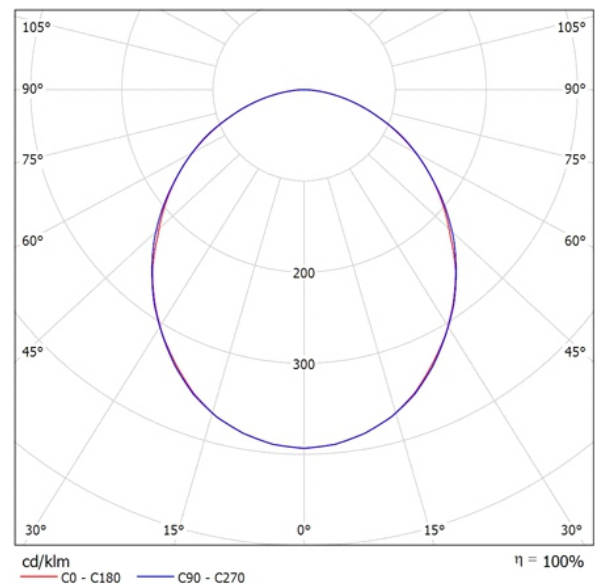

Technical Info

Product	Size	Listed	Light Outpt (Lm)	Wattage (W)	Efficacy (LM/W)	CCT (K)	CRI (%)
GDX 700 14K308	1x4	Standard	3916,5	37,5	104,5	3000	82,5
GDX 700 14K358			3863,9	37,5	103,1	3500	82,8
GDX 700 14K408			4076,6	37,5	108,8	4000	83,2
GDX 700 14K508			4236,7	37,5	113,0	5000	83,8
GDX 700 22K308	2x2	Standard	3816,3	37,9	100,7	3000	82,5
GDX 700 22K358			3894,3	37,9	102,8	3500	82,4
GDX 700 22K408			3972,3	37,9	104,9	4000	83,2
GDX 700 22K508			4128,3	38,8	106,4	5000	83,8
GDX 700 24K308	2x4	Standard	4707,3	43,5	108,2	3000	82,5
GDX 700 24K358			4803,5	43,5	110,4	3500	82,8
GDX 700 24K408			4899,7	43,5	112,6	4000	83,2
GDX 700 24K508			5092,1	43,5	117,1	5000	83,8



GDX 700

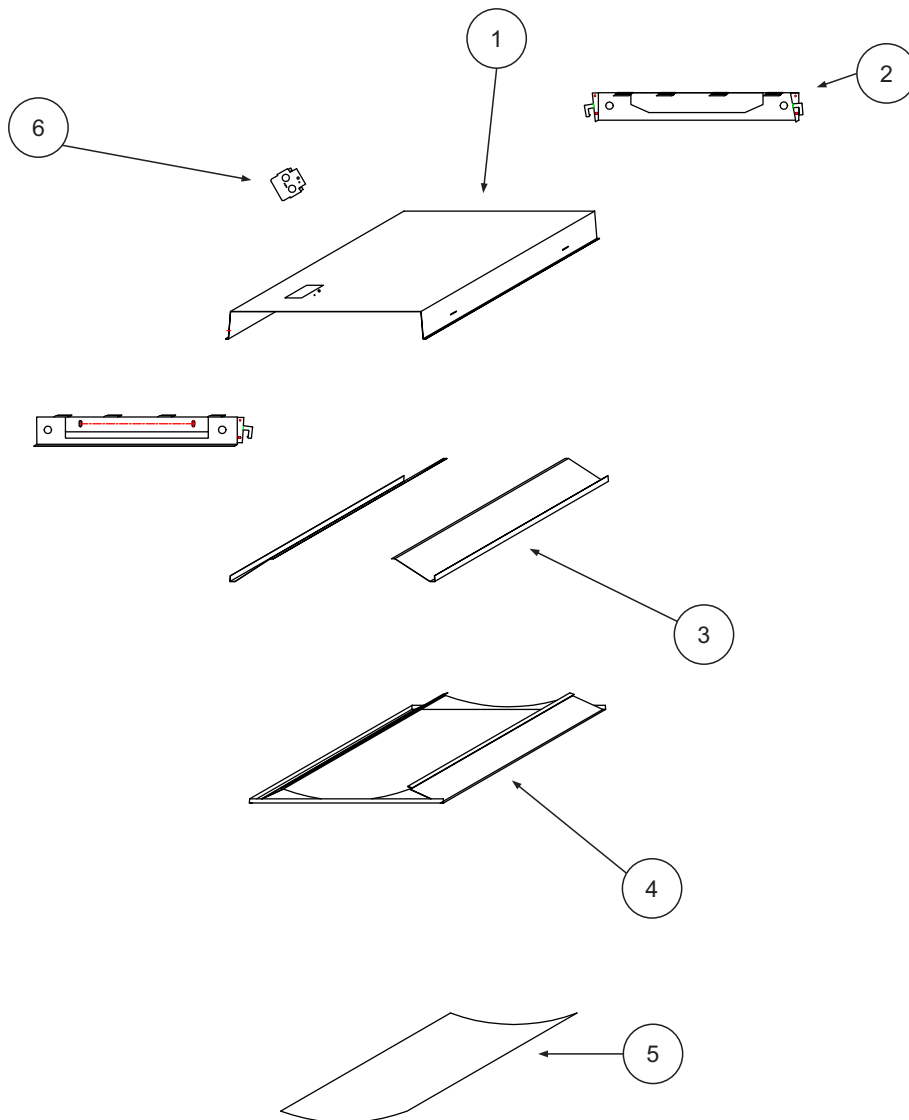

ITEM	QTY	DESCRIPTION	PART NUMBER
1	1	Body	700 2410
2	2	Headboard	700 2231
3	2	Side Reflector	700 2442
4	1	Door Frame	700 2408
5	1	Plastic Lens	700 2451
6	1	Access Plate	510 15



VMD 694



Features and Benefits

- Recessed or surface mounted;
- Post Painted in Matte White Finish with 92% reflectance;
- Acrylic Technical Frosted difuser with 90% light transmission;
- Formed and welded in 24 Gauge Steel;
- Easy removal of diffuser, without any tools;
- Customized LED Pattern Holes available, verify with the Factory;
- Volumetric Low Cost Center Lens;

Dimensions

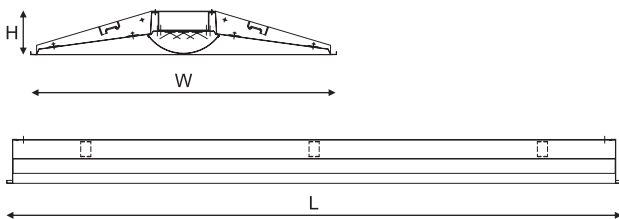

DIMENSIONS	LAMPS	H	W	L
1x4	Led	3.36	11.84	47.71
2x2	Led	3.36	23.72	23.72
2x4	Led	3.36	23.72	47.71

Polar Curve

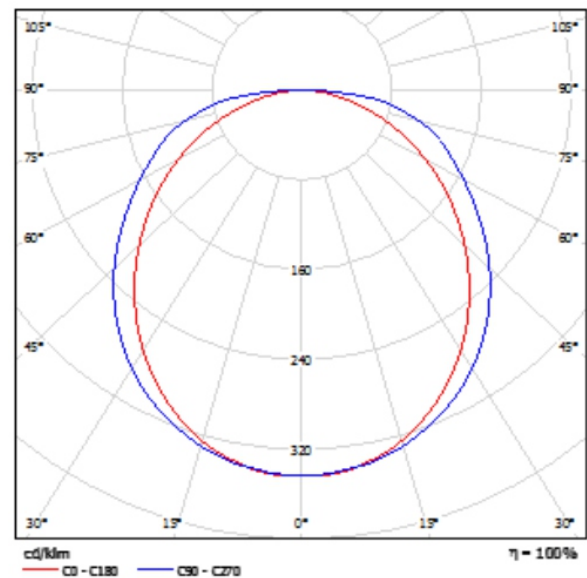

Technical Info

Product	Size	Listed	Light Outpt (Lm)	Wattage (W)	Efficacy (LM/W)	CCT (K)	CRI (%)
VMD 694 14K308	1x4	Standard	3916,5	37,5	104,5	3000	82,5
VMD 694 14K358			3863,9	37,5	103,1	3500	82,8
VMD 694 14K408			4076,6	37,5	108,8	4000	83,2
VMD 694 14K508			4236,7	37,5	113,0	5000	83,8
VMD 694 22K308	2x2	Standard	3816,3	37,9	100,7	3000	82,5
VMD 694 22K358			3894,3	37,9	102,8	3500	82,4
VMD 694 22K408			3972,3	37,9	104,9	4000	83,2
VMD 694 22K508			4128,3	38,8	106,4	5000	83,8
VMD 694 24K308	2x4	Standard	4707,3	43,5	108,2	3000	82,5
VMD 694 24K358			4803,5	43,5	110,4	3500	82,8
VMD 694 24K408			4899,7	43,5	112,6	4000	83,2
VMD 694 24K508			5092,1	43,5	117,1	5000	83,8



VMD 694

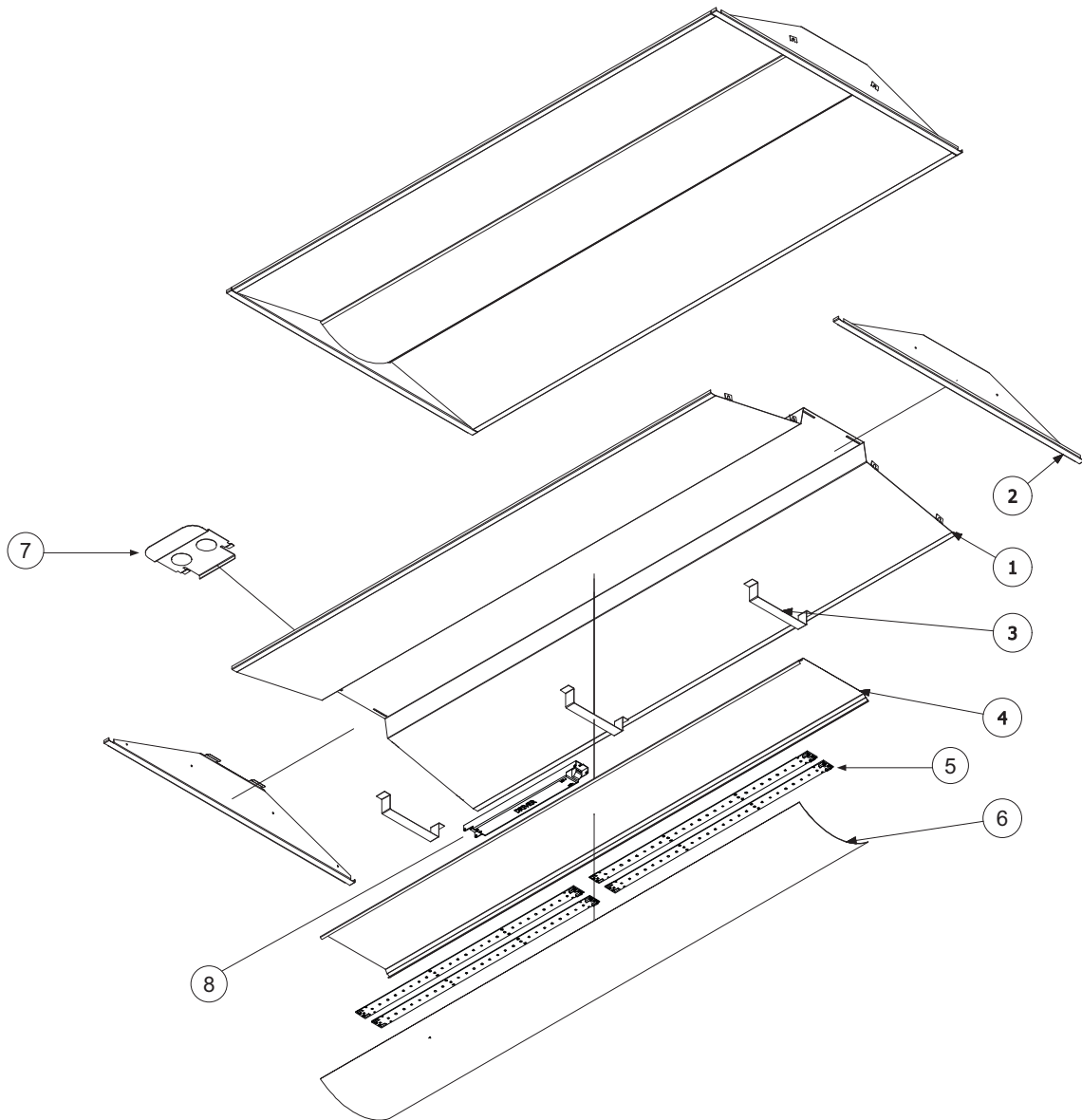

ITEM	QTY	DESCRIPTION	PART NUMBER
1	1	Body	1694 2410
2	2	Headboard	1694 2231
3	3	Chassis Support	1694 04
4	2	LED Board	--
5	1	Led Chassis	1694 2406
6	1	Plastic Lens	1694 2452
7	1	Access Plate	510 15
8	1	Power Supply	--



VPL 601



Features and Benefits



- Recessed or Surface Mounted;
- Post Painted in Matte White Finish with 92% reflectance;
- Perforated Steel and Acrylic Technical Frosted Diffuser;
- Formed and welded in 24 Gauge Steel;
- Customized LED Pattern Holes available, verify with the Factory;
- Volumetric Low Cost Center Lens;

Dimensions

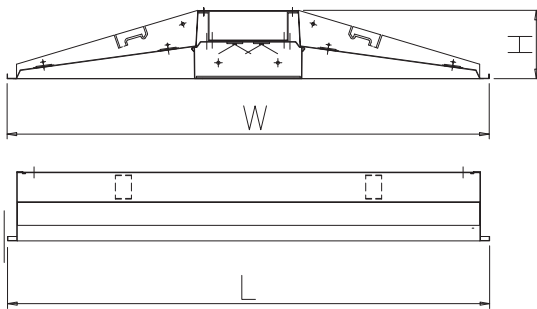

DIMENSIONS	LAMPS	H	W	L
1x4	Led	3.36	11.84	47.71
2x2	Led	3.36	23.72	23.72
2x4	Led	3.36	23.72	47.71

Polar Curve

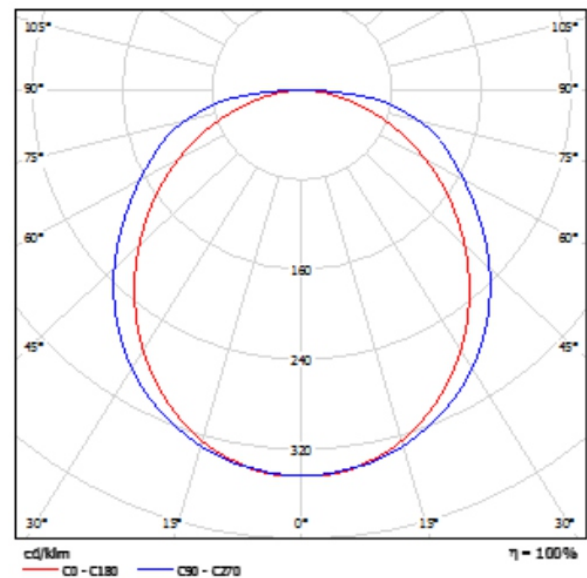

Technical Info

Product	Size	Listed	Light Outpt (Lm)	Wattage (W)	Efficacy (LM/W)	CCT (K)	CRI (%)
VPL 601 14K308	1x4	Standard	3916,5	37,5	104,5	3000	82,5
VPL 601 14K358			3863,9	37,5	103,1	3500	82,8
VPL 601 14K408			4076,6	37,5	108,8	4000	83,2
VPL 601 14K508			4236,7	37,5	113,0	5000	83,8
VPL 601 22K308	2x2	Standard	3816,3	37,9	100,7	3000	82,5
VPL 601 22K358			3894,3	37,9	102,8	3500	82,4
VPL 601 22K408			3972,3	37,9	104,9	4000	83,2
VPL 601 22K508			4128,3	38,8	106,4	5000	83,8
VPL 601 24K308	2x4	Standard	4707,3	43,5	108,2	3000	82,5
VPL 601 24K358			4803,5	43,5	110,4	3500	82,8
VPL 601 24K408			4899,7	43,5	112,6	4000	83,2
VPL 601 24K508			5092,1	43,5	117,1	5000	83,8



VPL 601

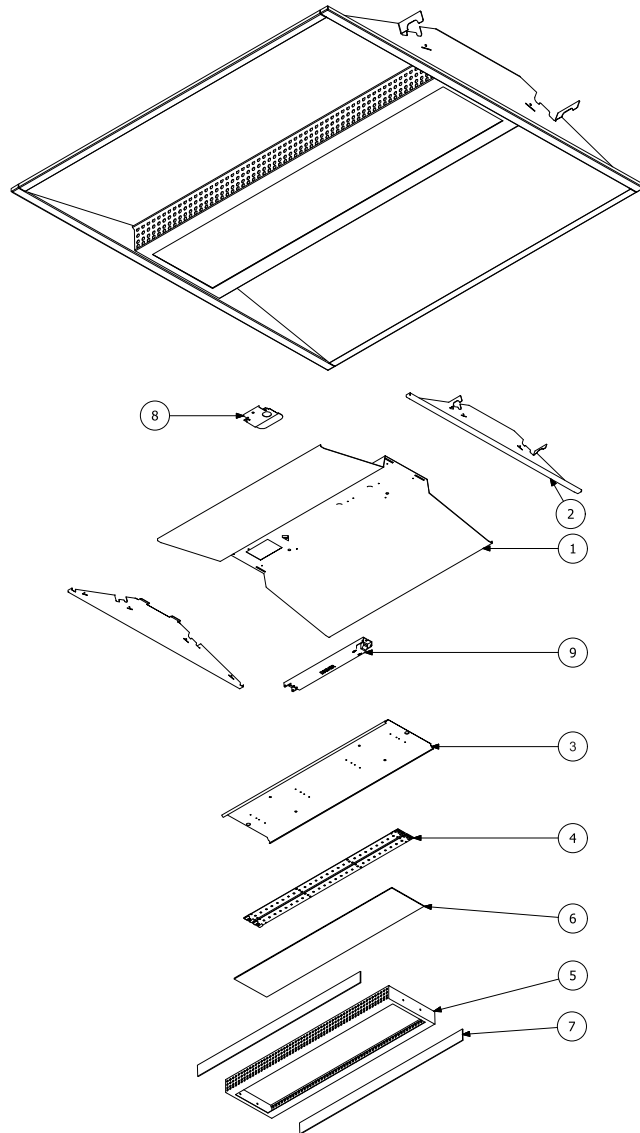

ITEM	QTY	DESCRIPTION	PART NUMBER
1	1	Body	1694 2210
2	2	Headboard	1694 2231
3	1	Led Chassis	1694 2206
4	2	Led Boards	--
5	1	Perforated Square Diffuser	1601 2282
6	1	Central Plastic Lens	1601 2251
7	2	Side Plastic Lens	1601 2252
8	1	Acces Plate	510 15



TRK 300



Features and Benefits

- Installed in any Troffer in the market;
- Lens or Parabolic Troffer Retrofit;
- Easier and Faster Installation;
- Acrylic Technical Frosted Diffuser with 90% light transmission;
- Formed and welded in 24 gauge steel;
- Post Painted in matte white finish with 92% reflectance;
- Customized LED Pattern holes available, verify with the factory;

Dimensions

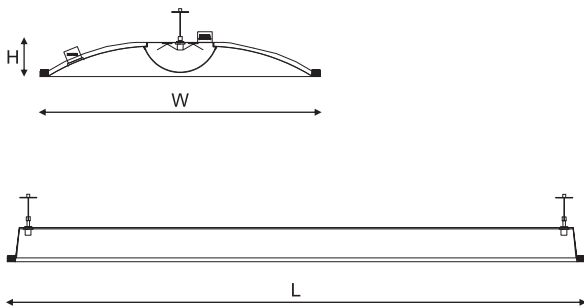

DIMENSIONS	LAMPS	H	W	L
1x4	Led	2.36	10.62	46.65
2x2	Led	2.75	22.62	22.66
2x4	Led	2.75	22.62	46.65

Polar Curve

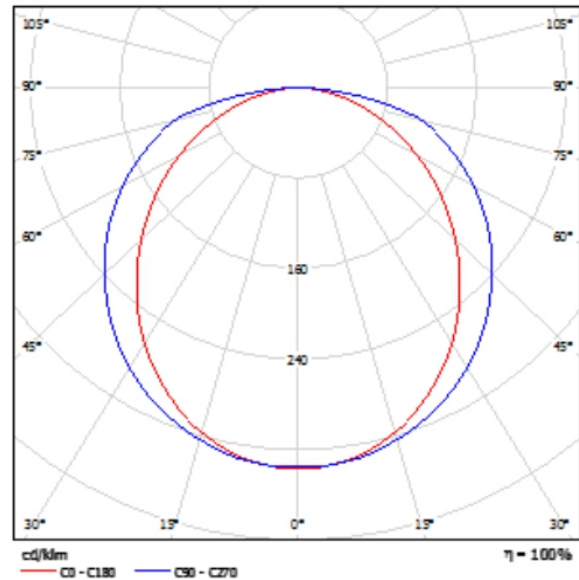

Technical Info

Product	Size	Listed	Light Outpt (Lm)	Wattage (W)	Efficacy (LM/W)	CCT (K)	CRI (%)
TRK 300 14K308	1x4	Standard	3884,6	37,5	103,6	3000	83,1
TRK 300 14K358			3967,5	37,5	105,8	3500	83,4
TRK 300 14K408			4050,4	37,5	108,0	4000	83,7
TRK 300 14K508			4216,1	38,1	110,6	5000	84,2
TRK 300 22K308	2x2	Standard	3807,8	38,9	97,9	3000	83,1
TRK 300 22K358			3889,0	38,9	100,0	3500	83,4
TRK 300 22K408			3970,3	38,9	102,1	4000	83,7
TRK 300 22K508			4132,8	38,9	106,3	5000	84,2
TRK 300 24K308	2x4	Standard	3643,0	33,9	107,6	3000	83,1
TRK 300 24K358			3720,7	33,9	109,9	3500	83,4
TRK 300 24K408			3798,4	33,9	112,2	4000	83,7
TRK 300 24K508			3953,9	33,9	116,8	5000	84,2



TRK 300

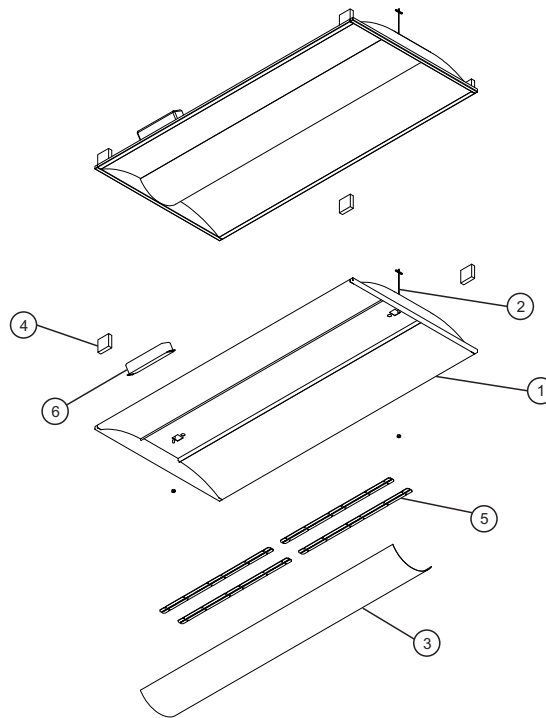

ITEM	QTY	DESCRIPTION	PART NUMBER
1	1	Body	300 1410
2	2	Seuspension	300 18
3	1	Lens	300 2452
4	4	Foam With Spring Effect	300 39
5	2	LED Board	--
6	1	Driver	--

Illustrative 3D Design - Wire Connection

- 01**

Turn Off the power in the old troffer. Open the louver and take the parabolic cover or lens, lamps, ballast cover, ballast, sockets out. Only leave the powr cable and ground wire in the old fixture.
- 02**

Make two holes (minimum 0.32 in [8 mm]) to attach the seuspension in the old house. Sometimes old houses already have holes that you can use.
- 03**

Pass the cable of the suspension through the holes of the old housing. After that connect the cable into the pins of the suspension that are already installed in the retrofit.

Make sure that the retrofit is fixed by the two suspension cables.
- 04**

Once it's hung, connect the he power cables.
- 05**

As long you pull the cables, you pull up the retrofit. Support the fixture with your hands until it attaches and fit well inside of the old housing.
- 06**

Pass the cables behind of the retrofit kit through the squire holes, hiding it and avoiding any shadow on the lens. Then bend the lens and put on place to finish the installation.





Since 1953



REPRESENTED BY SLP LIGHTING
1400 S. OLD HIGHWAY 141
FENTON, MO 63026 USA
PHONE: 800.248.0224 / 636.600.4084
SALES@SLPLIGHTING.COM
WWW.SLPLIGHTING.COM



www.lighttoolinternational.com
caio@lighttool.com.br
+1 (786) 757-3909

