



Citadel Update

PROVIDING QUALITY LIGHTING COMPONENTS AND SOLUTIONS SINCE 1969



NEW CIRA LENS:

Ideal For Agriculture Areas

○ CT2-CIRA-2L4

Smooth Sleek Design

Optically Clear or
FR50 Frosted

Fits over LED or Fluorescent
lighting



CT2-CIRA(CP)-2L4



CT2-DIRA(DP)-2L4

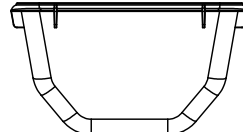

CT2-LIRA-2L4

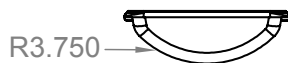

R3.750



2.031

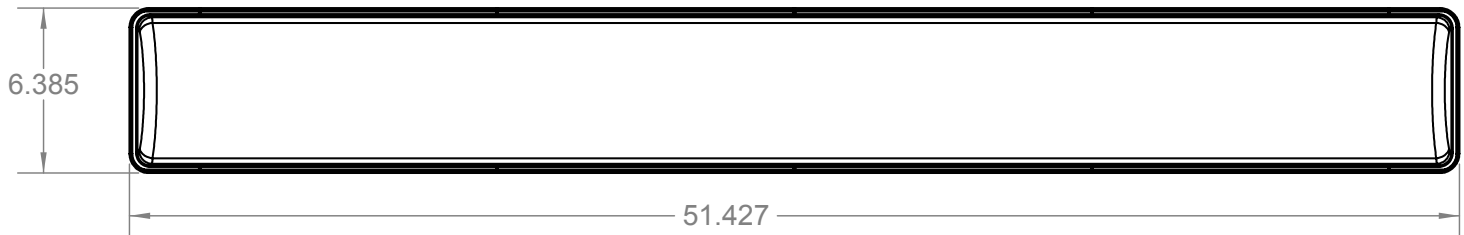

6.385

51.427



Citadel 2:
CIRA LENS

CITADEL 2™
 Shallow, Smooth Lens for LED lighting.

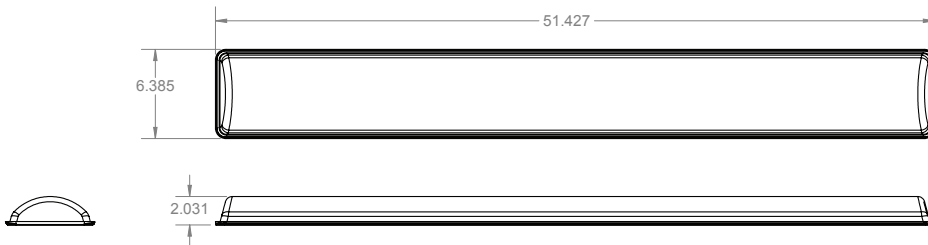

Performance

2 Lamp 54W T5HO

Lens	LUMENS	Lamp %
CIRA	8983	89.8

2 Lamp 32W T8

Lens	LUMENS	Lamp %
CIRA	4762	80.7

- Extremely Efficient

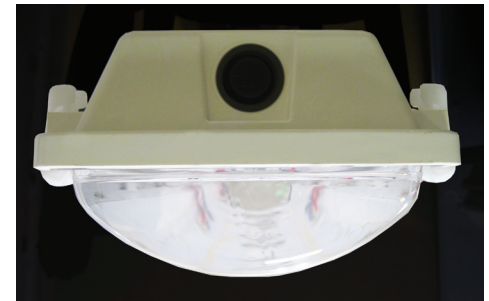
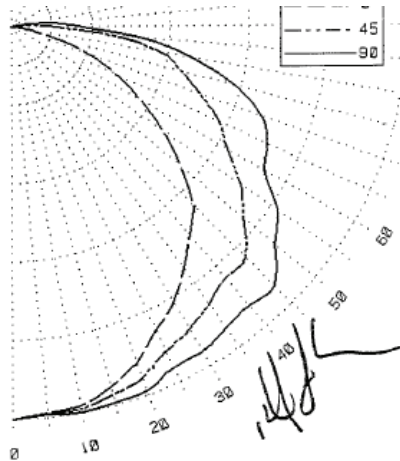

Features & Benefits

- Shallow and Smooth for even distribution
- No Striations
- Available for 2 Light 4 Foot Enclosures
- 51.4" Long, 6.4" Wide, 2" Deep
- Designed for complete compatibility with LEDs
- Optically Clear or FR50 Frosted
- Impact Modified Acrylic: CT2-CIRA-2L4/CT2-CIRA-2L4-FR50
- Polycarbonate: CT2-CP-2L4/CT2-CP-2L4-FR50



Ratings & Listings

- Components Tested & Certified by NSF International

Applications

- LED Enclosures

Product offering and specifications subject to change without notice.