

SLP CITADEL™ 2 & 3 SAFETY STRAP INSTALLATION



FROM THE FACE SIDE OF THE GEARTRAY INSERT THE END OF THE SAFETY STRAP THAT HAS A RING ON IT THROUGH THE OBOUND HOLE. (TWO SAFETY STRAPS REQUIRED PER GEARTRAY.)



PULL THE SAFETY STRAP THROUGH THE OBOUND HOLE UNTIL THE TWO ANGLED BARBS PASS THROUGH THE HOLE.

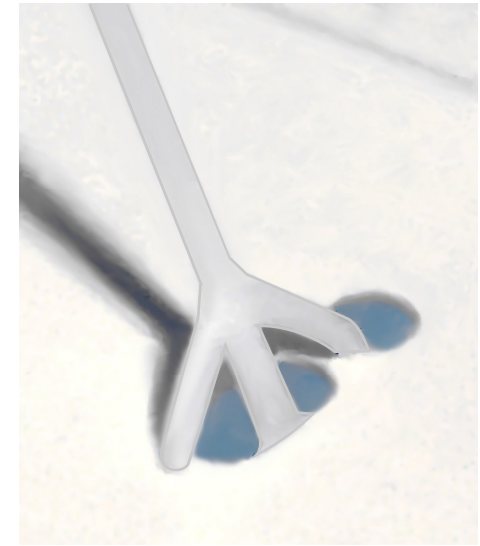

(SHOWN FROM THE BACK SIDE OF THE GEARTRAY.) THE SAFETY STRAP IS NOW SECURED TO THE GEARTRAY.



ATTACH THE RING END OF THE SAFETY STRAP TO THE GEARTRAY RETAINER CLIP AS INDICATED

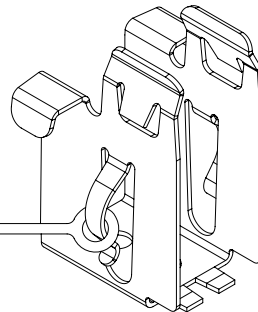

		Polyamide Material.	Remark.
Name. JCT	CITADEL 2 & 3		
Check.	Safety strap installation instructions		
Control.			



Scientific Lighting Products

1400 South Old Highway 141, Fenton, MO 63026 USA
Tel. 636-600-4084 - Fax 636-600-4108

V070605