

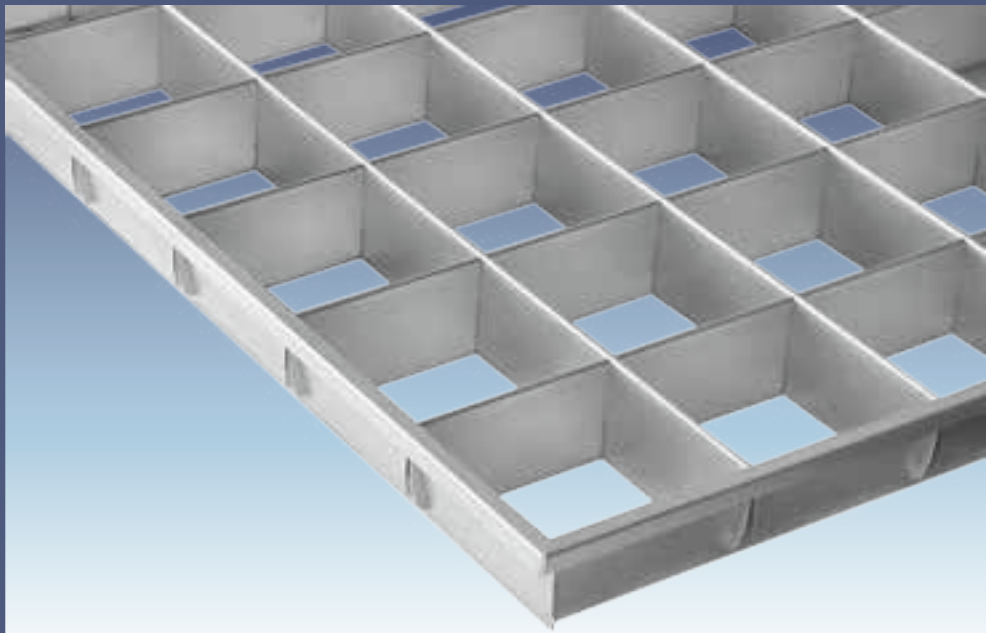

ALUMINUM PRODUCTS

Products for a today's office environment



- PARABOLIC ALUMINUM LOUVERS
- BAFFLES
- RETROFIT KITS
- ALUMINUM EGGCRATE
- HARDWARE

Baffles



Straight Blade Baffle ATTB:

The elemental simplicity of Aluminum Thincell Straight Blade Baffles compliment the widest range of interior decors. The crisp 45 cut-off of the stock parts provides uniform shielding from the light source while maintaining a visual warmth not associated with parabolics. Stock parts are finished with white enamel paint, have cross blades 1" (25mm) deep, 1" (25mm) on center and are available in trimmable widths. ATTB's straightness and rigidity are assured by the formed side details. Custom widths, blade centers and side details are available for luminaires and ceiling applications.

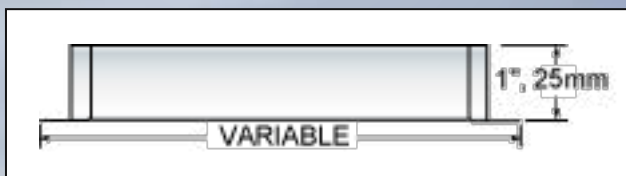

Parabolic Aluminum Baffle LB14 is available as highly adaptable stock parts or can be manufactured to meet specific requirements. Stock parts feature cross blades either 2" (51mm) or 3" (76) on center and of parts meeting almost any dimensional requirement. These nonflammable aluminum baffles are 1.4" (35mm) deep to assure maximum luminance control. Each 4' part begins and ends with a half cell (1" or 1-1/2") so that the baffles can be butted end to end for a continuous appearance.



RFK3 Retrofit System



RFK3™ is a comprehensive series of 3" deep parabolic aluminum retrofit kits. These assemblies are designed to be installed between an existing luminaire and the inverted tee bar ceiling system. The louvers are secured to the frame with steel tee hinges and spring loaded latches.

Materials: black painted steel and anodized aluminum.



Standard Product:

2'x4': 18 or 32 cell | 2'x2': 9 or 16 cell

Custom sizes and configuration are available.

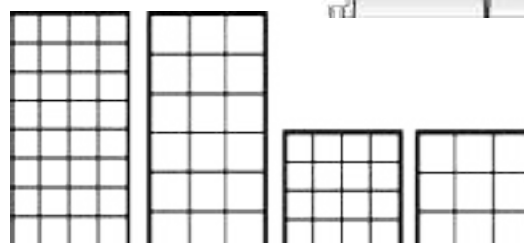

Aluminum Hardware

Springs for L30 Louvers: With a right hand spring and a left hand spring the latches work more freely. The small diameter wire allows for a standard rivet to be used.

Left Spring



Right Spring



Hinges

Spring Hinge:

Available in Black Anodized and White



Cam Hinge:

Available in Silver



Latches

Spring Latch: Available in White and Black Anodized



Cam Latch: Available in White and Silver



Rivets

Rivet for Cam



Rivet for Wrap Around Tab



Black Pop Rivet for Hinges and Springs



Rivet for Spring Latch





Aluminum Products For Today's Office Environment

Aluminum Louvers and Baffles are ideal for producing the comfortable, yet dramatic lighting demanded in today's office and workplace.

Parabolic Aluminum Louvers

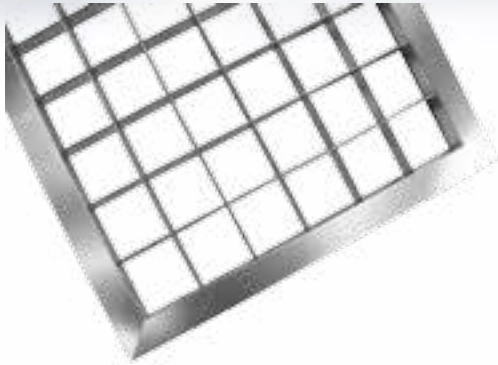

Lumiflux L14 is the industry standard shallow parabolic aluminum louver. It is available from stock with a trimmable flange that provides a wide range of finished sizes. L14 is designed to fit most luminaires and is available in the cell configurations that satisfy typical applications.

Lumiflux L30 is a highly versatile nominal 3" (67mm) parabolic aluminum louver that is suited to ceiling and luminaire applications. Variable configurations and blade spacing offer the optimum light control for each installation. This large scale louver is available in sizes up to 63" (1600mm) square when flanged. Spring loaded latches, hinges and optional wrap tabs can be attached to the perimeter to fit the fixture.



Wrap Tab



Lumiflux L25 is a high side louver available in White and Semi-specular finish. The blades widely angled to address the need for vertical footcandles without sacrificing horizontal levels. This luminaire has optics that are best suited for situations requiring an extremely broad distribution at high angles. This produces extraordinarily high vertical footcandles, making it ideal for the retail marketplace. Made to Order.

Thincell Aluminum Eggcrate

Finishes: baked white enamel, mill finish, clear anodized or black enamel. Other cell sizes available

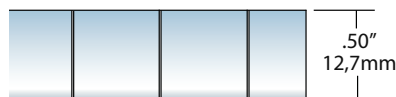
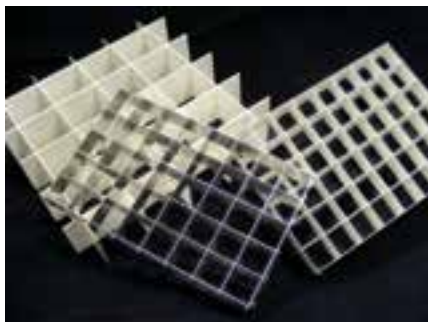

AT: 1/2" cube aluminum

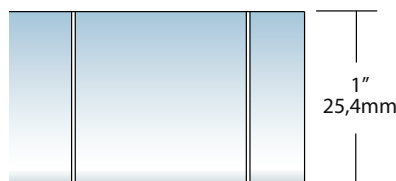

AT1: 1" cube aluminum



Aluminum Knockdown Products

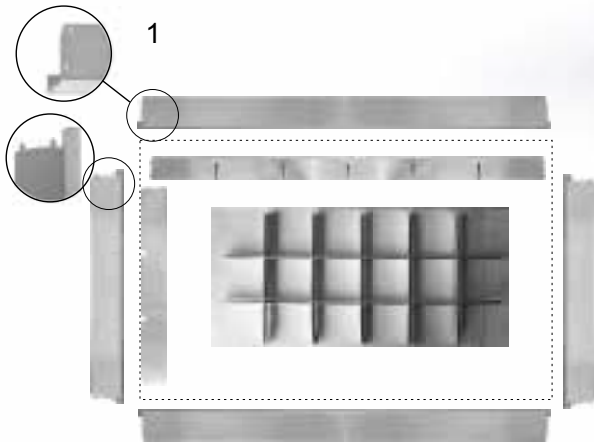

SLP's Knockdown Product

Lumiflux L30 is a highly versatile nominal 3"/67mm parabolic aluminum louver that is suited to ceiling and luminaire applications. Variable configurations and blade spacing offer the optimum light control for each installation. This large scale louver is available in sizes up to 63" (1600mm) square when flanged. Spring loaded latches and hinges can be attached to the perimeter to fit the fixture.

These parts are available in a Specular and Semi-Specular anodized or high reflective White finish.

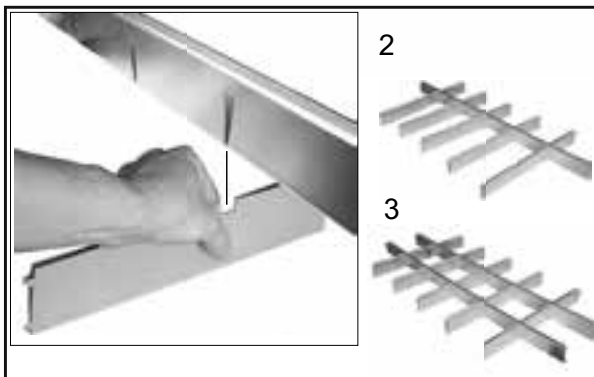

Component parts include:

- Cross Blades
- Longitudinal Blades
- Hinges Flanges
- Hinges
- Latches: Spring-Loaded or Cam
- Latch Flanges
- Rivets

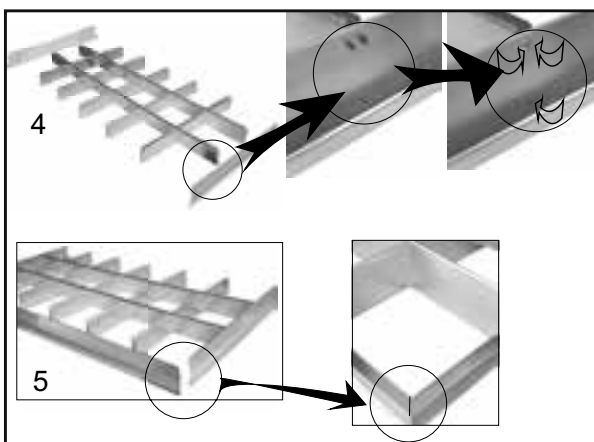

Lumiflux L14 is the industry standard 1.4" (35mm) deep parabolic aluminum louver. It is available with a trimmable flange that provides a wide range of finished sizes. L14 is designed to fit most luminaires and is available in multiple configurations.

Component parts include:

- Cross Blades
- Longitudinal Blades
- Flanges

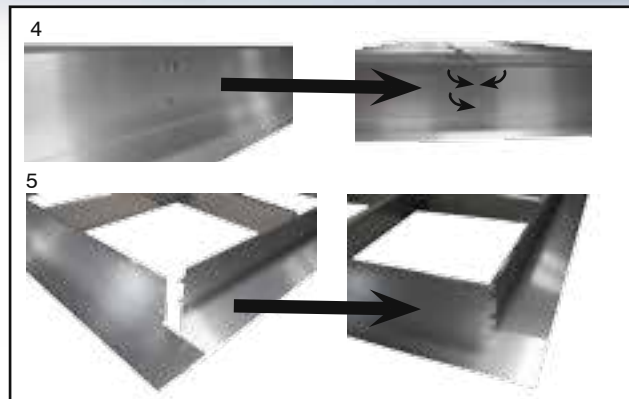
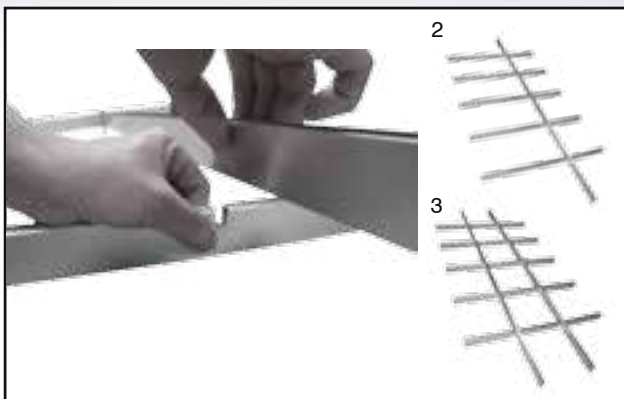
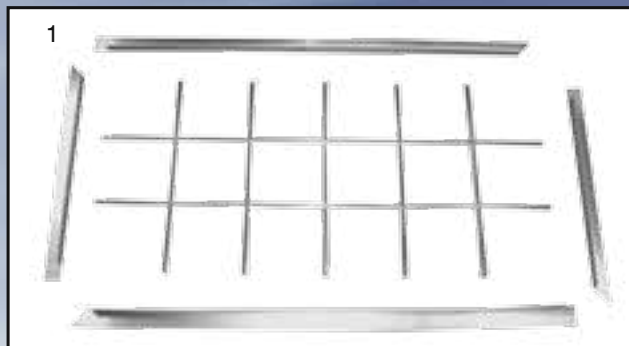

SLP's Knockdown Packaging can save money on shipping. Aluminum knockdown components pack neatly into multiple small boxes as opposed to assembled product on multiple large skids.

Knockdown Product



Assembled Product

